

TECHNICAL MANUAL
ORGANIZATIONAL, DIRECT SUPPORT,
AND GENERAL SUPPORT
MAINTENANCE REPAIR PARTS AND
SPECIAL TOOLS LISTS
(INCLUDING DEPOT MAINTENANCE
REPAIR PARTS AND SPECIAL TOOLS)
FOR
TESTS SETS,
RADAR AN/APM-246
(NSN 6625-00-943-2059)
AND AN/APM-247
(NSN 6625-00-908-9577)

HEADQUARTERS, DEPARTMENT OF THE ARMY

SEPTEMBER 1976

**ORGANIZATIONAL, DIRECT SUPPORT, AND GENERAL SUPPORT
 MAINTENANCE REPAIR PARTS AND SPECIAL TOOLS LISTS
 (INCLUDING DEPOT MAINTENANCE REPAIR PARTS AND SPECIAL TOOLS)**

**FOR
 TEST SETS, RADAR AN / APM-246 (NSN 6625-00-943-2059)**

AND AN / APM-247 (NSN 6625-00-908-9577)

Current as of 29 April 1976

REPORTING OF ERRORS

You can improve this manual by recommending improvements using DA Form 2028-2 (Test) located in the back of the manual. Simply tear out the self-addressed form, fill it out as shown on the sample, fold it where shown, and drop it in the mail.

If there are no blank DA Form 2028-2 (Test) in the back of your manual, use the standard DA Form 2028 (Recommended Changes to Publications and Blank Forms) and forward to the Commander, US Army Electronics Command, ATTN: DRSEL-MA-Q, Fort Monmouth, New Jersey 07703.

In either case, a reply will be furnished direct to you.

Table of Contents

		Page	Illus Figure
Section	I. Introduction.....	1	
	II. Repair parts list 4AN/AMP-246)	5	
Group	00 Test Set, Radar AN/APM-246	5	1
	01 Test Set, Radar, Preflight TS-2154()/APM-246	7	2-4
	02 Waveguide Assembly CG-3098/APM-246 (See next higher assembly)		
	03 Cable Assemblies for AN/APM-246	15	
	0301 Cable Assembly, Special Purpose, Electrical CX-10030()/APM-246	15	5
	0302 Cable Assembly, Special Purpose, Electrical CX-10031()/APM-246	15	5
	0303 Cable Assembly, Special Purpose, Electrical CX-10032()/APM-246	15	5
	0304 Cable Assembly, Special Purpose, Electrical CX-10033()/APM-246	15	5
	0305 Cable Assembly, Special Purpose, Electrical CX-10034()/APM-246	15	5
	0306 Cable Assembly, Special Purpose, Electrical CX-10035()/APM-246	15	5
	04 Bulk material	16	
Section	III Special tools list (AN/APM-246) (Not applicable)		
	IV National stock number and part number index (AN/APM-246)	18	
	V Repair parts list (AN/APM-247)	23	
Group	00 Test Set, Radar AN/APM-247	23	6
	01 Test Set, Radar TS-2081()/APM-247	27	7-12
	02 Cable Assemblies for AN/APM-247	51	
	0201 Cable Assembly, Power, Electrical CX-10029/APM-247	51	13
	0202 Cable Assembly, Special Purpose, Electrical CX-11555/APM-247	51	13
	0203 Cable Assembly, Special Purpose, Electrical CX-10242/APM-247	51	13
	0204 Cable Assembly, Radio Frequency CG-1464/U.....	51	13

***This manual supersedes so much of TM 11-6625-664-12, 28 June 1966, including all changes, and TM 11-6625-664-45, 10 May 1967, as pertains to repair parts and special tools lists.**

		Page	Illus Figure
Section	03 Bulk material	52	
	VI Special tools list (AN/APM-247) (Not applicable)		
	VII National stock number and part number index (AN/APM-247)	54	

SECTION I

INTRODUCTION

1. Scope

This manual lists repair parts required for performance of organizational and general support maintenance of the AN/APM-246 and AN/APM-247.

2. General

This Repair Parts and Special Tools List is divided into the following sections:

a. *Section II. Repair Parts List (AN/APM-246).* A list of repair parts authorized for use in the performance of maintenance. The list also includes parts which must be removed for replacement of the authorized parts. Parts lists are composed of functional groups in ascending numerical sequence, with the parts in each group listed in figure and item number sequence. Bulk materials are listed in NSN sequence.

b. *Section III Special Tools List (AN/APM-246).* Not applicable.

c. *Section IV National Stock Number and Part Number Index (AN/APM-246).* A list, in ascending numerical sequence, of all National stock numbers appearing in the listings, followed by a list, in alphanumeric sequence, of all part numbers appearing in the listings. National stock number and part numbers are cross-referenced to each illustration figure and item number appearance.

d. *Section V Repair Parts List (AN/APM-247).* A list of repair parts authorized for use in the performance of maintenance. The list also includes parts which must be removed for replacement of the authorized parts. Parts lists are composed of functional groups in ascending numerical sequence, with the parts in each group listed in figure and item number sequence. Bulk materials are listed in NSN sequence.

e. *Section VI. Special Tools List (AN/APM-247).* Not applicable.

f. *Section VII. National Stock Number and Part Number Index (AN/APM-247).* A list, in ascending numerical sequence, of all National stock numbers appearing in the listings, followed by a list, in alphanumeric sequence, of all part numbers appearing in the listings. National stock number and part numbers are cross-referenced to each illustration figure and item number appearance.

3. Explanation of Columns

The following provides an explanation of columns found in the tabular listings:

a. *Illustration.* This column is divided as follows:

(1) *Figure number.* Indicates the figure number of the illustration in which the item is shown.

(2) *Item number.* The number used to identify each item called out in the illustration.

B Source, Maintenance, and Recoverability Codes (SMR).

(1) *Source code.* Source codes are assigned to support items to indicate the manner of acquiring support items for maintenance, repair, or overhaul of end items. Source codes are entered in the first and second positions of the Uniform SMR Code format as follows:

<i>Code</i>	<i>Definition</i>
PA--	Item procured and stocked for anticipated or known usage.
PD--	Support item, excluding support equipment, procured for initial issue or outfitting and stocked only for subsequent or additional initial issues or outfittings. Not subject to automatic replenishment.
XA--	Item is not procured or stocked because the requirements for the item will result in the replacement of the next higher assembly.
XD--	A support item that is not stocked. When required, item will be procured through normal supply channels.

NOTE

Cannibalization or salvage may be used as a source of supply for any items source coded above except those coded XA, XD, and aircraft support items as restricted by AR 700-42.

(2) *Maintenance code.* Maintenance codes are assigned to indicate the levels of maintenance authorized to USE and REPAIR support items. The maintenance codes are entered in the third and fourth positions of the Uniform SMR Code format as follows:

(a) The maintenance code entered in the third position will indicate the lowest maintenance level authorized to remove, replace, and use the support item. The maintenance code entered in the third position will indicate one of the following levels of maintenance:

Code	Application/Explanation
O--	Support item is removed, replaced, used at the organizational level.
H-	Support item is removed, replaced, used at the general support level.

(b) The maintenance code entered in the fourth position indicates whether the item is to be repaired and identifies the lowest maintenance level with the capability to perform complete repair (i.e., all authorized maintenance functions). This position will contain one of the following maintenance codes:

Code	Application/Explanation
H-	The lowest maintenance level capable of complete repair of the support item is the general support level.
Z--	Nonreparable. No repair is authorized.

(3) *Recoverability code.* Recoverability codes are assigned to support items to indicate the disposition action on unserviceable items. The recoverability code is entered in the fifth position of the Uniform SMR Code format as follows:

Recoverability

Codes	Definition
Z--	Nonreparable item. When unserviceable, condemn and dispose at the level indicated in position 3.
H--	Reparable item. When uneconomically repairable, condemn dispose at the general support level.
D--	Reparable item. When beyond lower level repair capability, return to depot. Condemnation and disposal not authorized below depot level.
A--	Item requires special handling or condemnation procedures because of specific reasons (i.e., precious metal content, high dollar value, critical material or hazardous material). Refer to appropriate manuals/directives for specific instructions.

c. National Stock Number. Indicates the National stock number assigned to the item and will be used for requisitioning purposes.

d. Part Number. Indicates the primary number used by the manufacturer (individual, company, firm, corporation, or Government activity), which controls the design and characteristics of the item by means of its engineering drawings, specifications standards, and inspection requirements, to identify an item or range of items.

NOTE

When a stock-numbered item is requisitioned, the repair part received may have a different part number than

the part being replaced.

e. Federal Supply Code for Manufacturer (FSCM). The FSCM is a 5-digit numeric code listed in SB 708-42 which is used to identify the manufacturer, distributor, or Government agency, etc.

f. Description. Indicates the Federal item name and, if required, a minimum description to identify the item.

g. Unit of Measure (U/M). Indicates the standard of the basic quantity of the listed item as used in performing the actual maintenance function. This measure is expressed by a two-character alphabetical abbreviation (e.g., ea., in, pr, etc.). When the unit of measure differs from the unit of issue, the lowest unit of issue that will satisfy the required units of measure will be requisitioned.

h. Quantity Incorporated in Unit. Indicates the quantity of the item used in the breakout shown on the illustration figure, which is prepared for a functional group, subfunctional group, or an assembly. A "V" appearing in this column in lieu of a quantity indicates that no specific quantity is applicable, (e.g., shims, spacers, etc.).

4. Special Information

The following publications pertain to the AN/APM-246 and AN/APM-247 and its components:
 TM 11-6625-664-12, Test Set, Radar AN/APM-246 and Test Set, Radar AN/APM-247
 TM 11-6625-664-45, Test Set, Radar AN/APM-246 and Test Set, Radar AN/APM-247

5. 'How to Locate Repair Parts

a. When National stock number or part number is unknown.

(1) *First.* Using the table of contents, determine the functional group within which the repair part belongs. This is necessary since illustrations are prepared for functional groups and listings are divided into the same groups.

(2) *Second.* Find the illustration covering the functional group to which the repair part belongs.

(3) *Third.* Identify the repair part on the illustration and note the illustration figure and item number of the repair part.

(4) *Fourth.* Using the Repair Parts Listing, find the figure and item number noted on the illustration.

b. When National stock number or part number is known.

(1) *First.* Using the Index of National Stock Numbers and Part Numbers, find the pertinent National stock number or part number. This index is in ascending NSN sequence followed by a list of part numbers in ascending alphanumeric sequence,

cross-referenced to the illustration figure number and item number.

(2) *Second.* After finding the figure and item number, locate the figure and item number in the repair parts list.

6. Abbreviations

Not applicable.

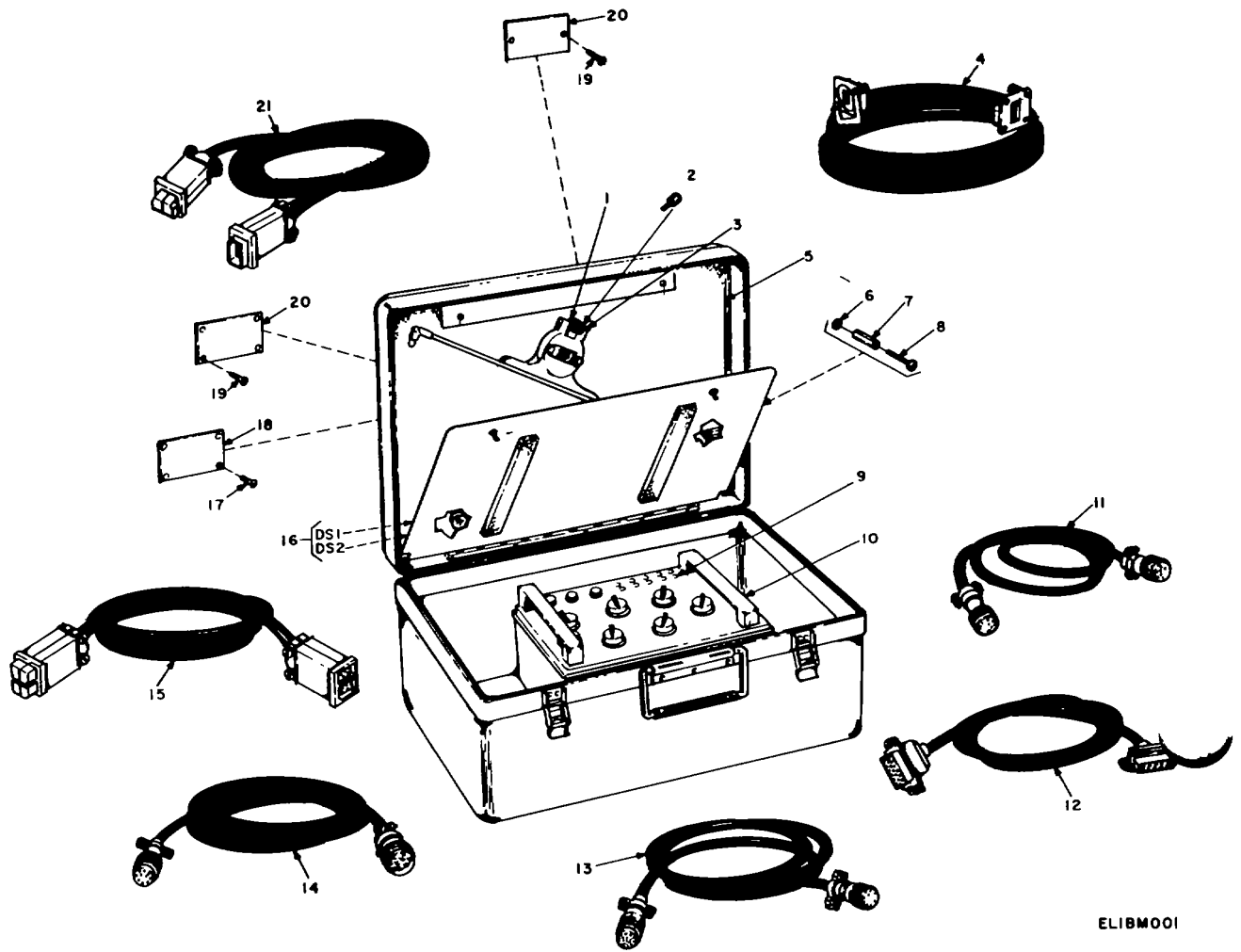

ELIBM001

Figure 1. Test Set, Radar AN/APM-246

SECTION II REPAIR PARS LIST (AN/APM-246)

(1) ILLUSTRATION		(2)	(3)	(4)	(5)	(6) DESCRIPTION	(7)	(8)
(a) FIG NO.	(b) ITEM NO.	SMR CODE	NATIONAL STOCK NUMBER	PART NUMBER	FSCM	USABLE ON CODE	U/M	QTY INC IN UNIT
1	1	XDHZZ		769-7059-001	13499	GROUP: 00 TEST SET, RADAR AN/APN-246 CLAMP	EA	1
1	2	XDHZZ		764-8614-001	13499	NUT, THUMB	EA	1
1	3	PDHHA	5210-00-999-1432	MX6613APM246	80058	SQUARE, COMBINATION	EA	1
1	4	PAHZZ	6625-00-943-2058	CG3098APM246	80058	WAVEGUIDE ASSEMBLY	EA	1
1	5	PDHHD	6625-00-943-2067	CY4475APM246	80058	CASE, TEST SET	EA	1
1	6	PAHZZ	5310-00-574-9790	8461219	19203	WASHER, FLAT	EA	1
1	7	PAHZZ	5365-00-950-6456	541-6017-002	13499	SLEEVE SPACER	EA	1
1	8	PAHZZ	5305-00-054-6652	MS51957-28	96906	SCREW, MACHINE	EA	1
1	9	PDHHD	6625-00-926-4402	TS2154APM246	80058	TEST SET, RADAR, PREFLIGHT	EA	1
1	10	XDHZZ		764-8529-001	13499	SUPPORT, HANDLE	EA	4
1	11	PAOHH	5995-00-926-0825	CX10030APM246	80058	CABLE ASSEMBLY, SPECIAL, PURPOSE, ELECTRICAL	EA	1
1	12	PAOHH	5995-00-926-0821	CX10031APM246	80058	CABLE ASSEMBLY, SPECIAL PURPOSE, ELECTRICAL	EA	1
1	13	PAOHH	5995-00-926-0822	CX10032APM246	80058	CABLE ASSEMBLY, SPECIAL PURPOSE, ELECTRICAL	EA	1
1	14	PAOHH	5995-00-926-0823	CX10033APM246	80058	CABLE ASSEMBLY, SPECIAL PURPOSE, ELECTRICAL	EA	1
1	15	PAOHH	5995-00-926-0824	CX10034APM246	80058	CABLE ASSEMBLY, SPECIAL PURPOSE, ELECTRICAL	EA	1
1	16	PAOZZ	6240-00-155-7857	MS25237-328	96906	LAMP, INCANDESCENT	EA	2
1	17	XDHZZ	5320-00-117-6816	MS20470AD3-5	96906	RIVET, SOLID	EA	4
1	18	XDHZZ		609-7448 -002	13499	PLATE, IDENTIFICATION	EA	1
1	19	PAHZZ	5320-00-754-0822	MS20470AD4-5	96906	RIVET, SOLID	EA	4
1	20	XDHZZ		609-7448-002	13499	PLATE, IDENTIFICATION	EA	2
1	21	PAOZZ	5995-00-926-0826	CX10035APM246	80058	CABLE ASSEMBLY, SPECIAL PURPOSE, ELECTRICAL	EA	1
					5			

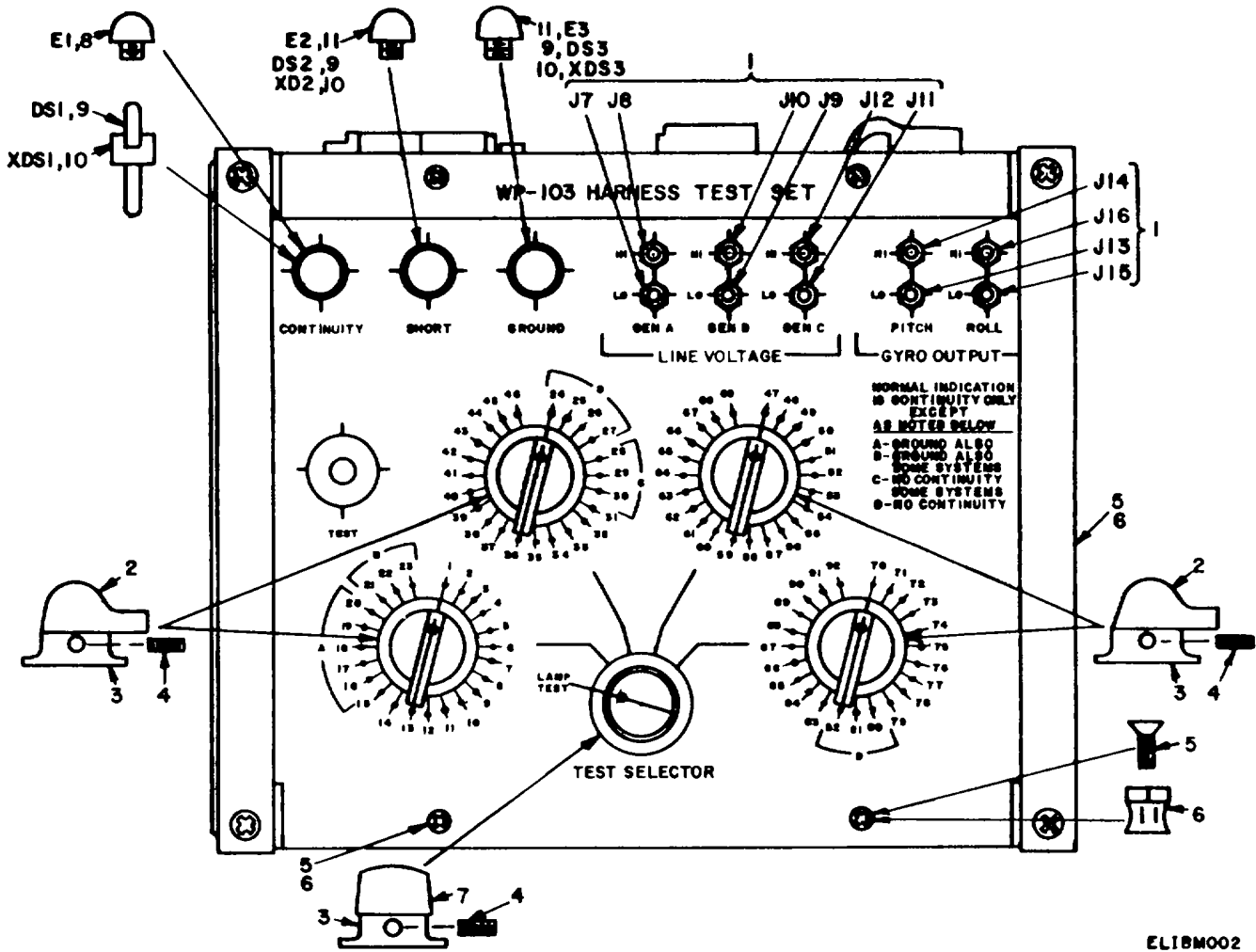

EL18M002

Figure 2. Test Set, Radar, Preflight TS-2154 ()/APM-246, front..

SECTION II REPAIR PARS LIST (AN/APM-246)

(1) ILLUSTRATION		(2)	(3)	(4)	(5)	(6) DESCRIPTION	(7)	(8)
(a) FIG NO.	(b) ITEM NO.	SMR CODE	NATIONAL STOCK NUMBER	PART NUMBER	FSCM	USABLE ON CODE	U/M	QTY INC IN UNIT
						GROUP: 01 TEST SET, RADAR, PRELIGHT TS-2154()/APM-246		
2	1	PAHZZ	5935-00-728-4514	M39024-10-01	81349	JACK, TIP	EA	10
2	2	PAOZZ	5355-00-931-3429	757-0230-002	13499	POINTER, DIAL	EA	4
2	3	PAOZZ	5895-00-928-7370	757-0220-002	13499	KNOB	EA	5
2	4	PAOZZ	5305-00-619-5475	AN565PC8H3	88044	SETSCREW	EA	5
2	5	XDHZZ		516-3498-030	13499	SCREW,MACHINE, MODIFIED	EA	8
2	6	PAHZZ	5307-00-679-4382	NCS6-4-12	07886	STUD, CAPTIVE	EA	8
2	7	PAOZZ	5355-00-931-1492	757-0228-002	13499	KNOB	EA	1
2	8	XDOZZ		8P6	87034	LENS, INDICATOR, LIGHT	EA	1
2	9	PAOZZ	6240-00-155-7857	MS25237-328	96906	LAMP, INCANDESCENT	EA	3
2	10	PAHZZ	6210-00-542-6882	14-3038087034		LIGHT, INDICATOR	EA	3
2	11	PAOZZ	6210-00-923-4666	6P6	87034	LENS, INDICATOR, LIGHT	EA	2
					7			

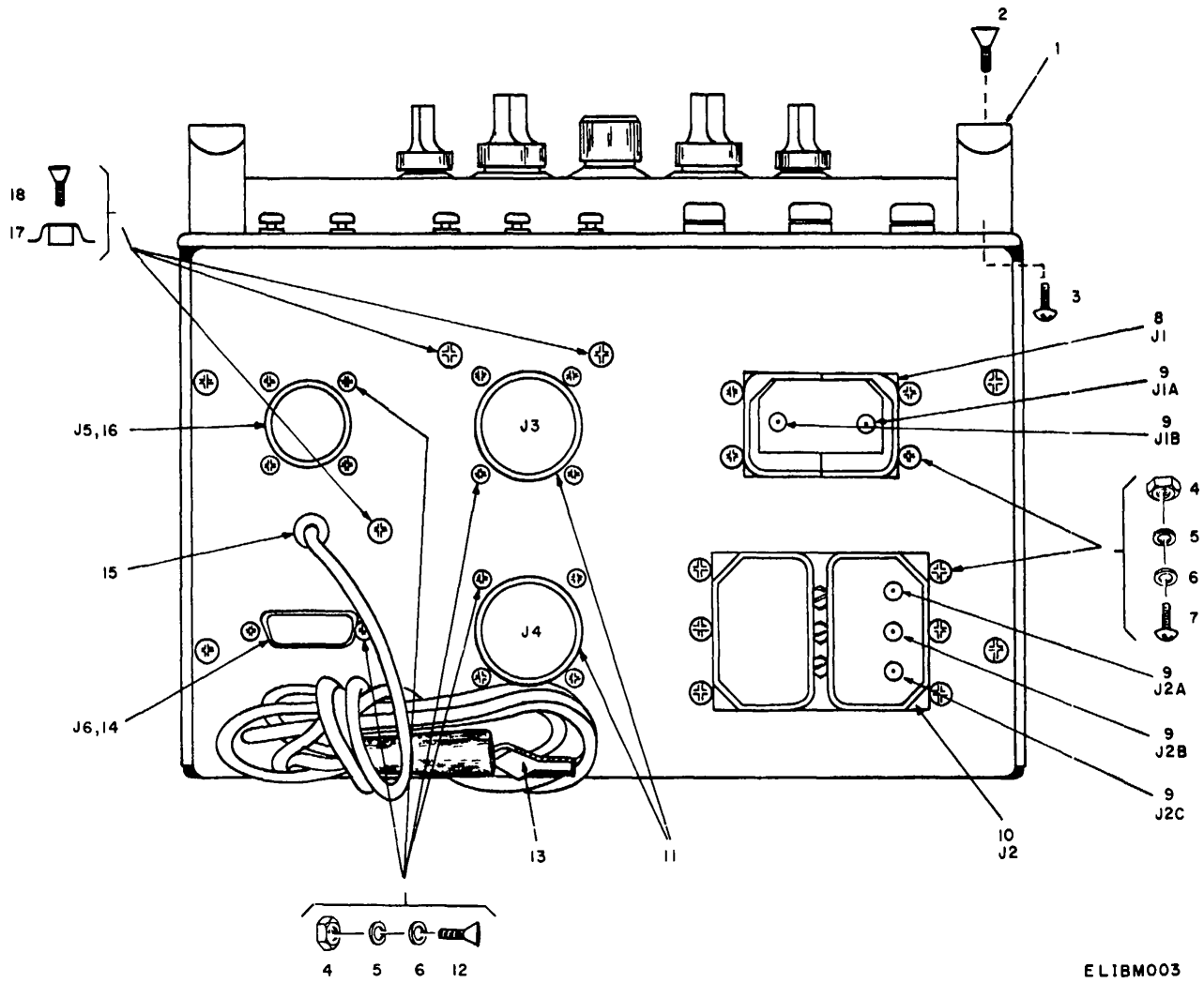

ELIBM003

Figure 3. Test Set, Radar, Preflight TS-2154 () /APM-246, rear.

SECTION II REPAIR PARS LIST (AN/APM-246)

(1) ILLUSTRATION		(2)	(3)	(4)	(5)	(6) DESCRIPTION	(7)	(8)
(a) FIG NO.	(b) ITEM NO.	SMR CODE	NATIONAL STOCK NUMBER	PART NUMBER	FSCM	USABLE ON CODE	UM	QTY INC IN UNIT
3	1	XDHZZ		764-8528-001	13499	HANDLE	EA	2
3	2	PAHZZ	5305-00-764-0070	H851959-46	96906	SCREW, MACHINE	EA	4
3	3	PAHZZ	5305-00-765-4257	NS51959-43	96906	SCREW, MACHINE	EA	24
3	4	PAHZZ	5310-00-208-3786	NAS671C14	80205	NUT, PLAIN, HEX	EA	24
3	5	PAHZZ	5310-00-933-8118	N35338-135	96906	WASHER, LOCK	EA	24
3	6	PAHZZ	5310-00-136-1631	310-6340-000	79807	WASER, FLAT	EA	24
3	7	PAHZZ	5305-o-054-56149	HS51957-15	96906	SCREW, MACHINE	EA	10
3	8	PAHZZ	5935-00-926-3011	DPXG32C2-34P	71468	CONNECTOR, RECPTACLE, ELECTRICAL	EA	1
3	9	XDHZZ		RY6621-23	94375	CONNECTOR, PLUG, ELECTRICAL	EA	5
3	10	XDHZZ		DPXR216C3P40 P3XA0773	71468	CONNECTOR, ASSEMBLY, ELECTRICAL	EA	1
3	11	PAHZZ	5935-00-087-80o9	PTO2A18-32P	77820	CONNECTOR, RECPTACLE, ELECTRICAL	EA	2
3	12	XDHZZ		556-3012-015	13499	SCREW, MACHINE, MODIIED	EA	14
3	13	PAHZZ	5999-00-065-1833	85	T65145	CLIP, ELECTRICAL	EA	1
3	14	PAHZZ	5935-00-064-1870	DA15PC33	711468	CONNECTOR, RECEPTACLE, ELECRICAL	EA	1
3	15	PAHZZ	5325-00-174-5317	MS35489-4	96906	GROMMET, RUBBER	EA	1
3	16	PAHZZ	5935-00-827-1336	371-2051-000	13499	CONNECTOR, RECEPTACLE, ELECTRICAL	EA	1
3	17	PAHZZ	5310-00-798-4847	F6-32SCL	83324	PRESS, NUT, FLOAT TYPE	EA	4
3	18	PAHZZ	5305-00-054-6652	MS51957-28	96906	SCREW, MACHIME	EA	4
					9			

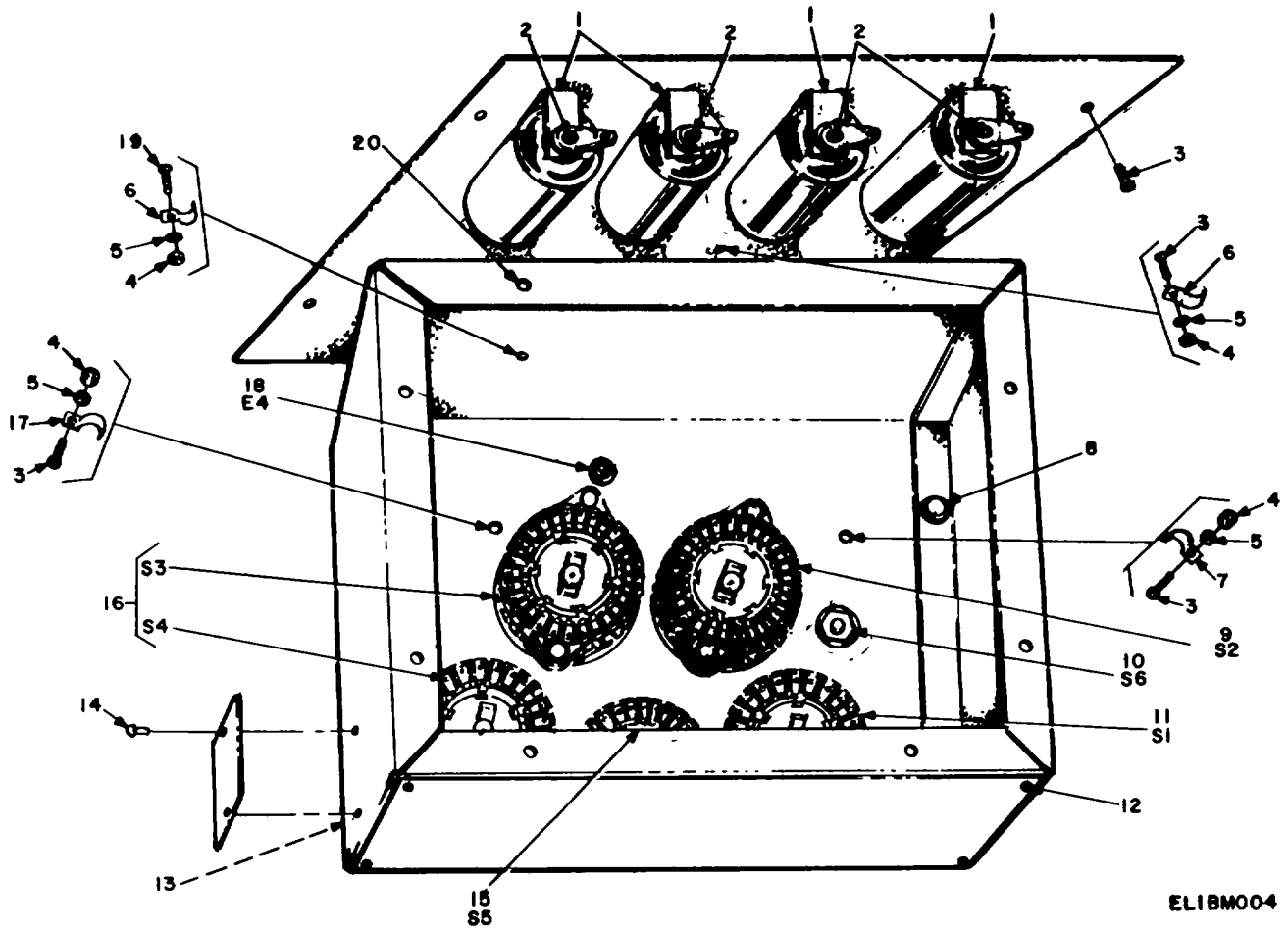

Figure 4. Test set, Radar, Preflight TS-2154 ()/APM-246, bottom.

SECTION II REPAIR PARTS LIST (AN/APM-246) (CONTINUED)

(1) ILLUSTRATION		(2)	(3)	(4)	(5)	(6) DESCRIPTION	(7)	(8)
(a) FIG NO.	(b) ITEM NO.	SMR CODE	NATIONAL STOCK NUMBER	PART NUMBER	FSCM	USABLE ON CODE	U/M	QTY INC IN UNIT
4	1	PAHZZ	6135-00-727-0449	2175	91833	RETAINER, BATTERY	EA	4
4	2	PAHZZ	5320-00-117-6949	MS20426AD4-4	96906	RIVET, SOLID	EA	8
4	3	XDHZZ		556-3012-0029	13499	SCREW, MACHINE, MODIFIED	EA	11
4	4	PAHZZ	5310-00-208-9457	P313-0045-000	77250	NUT, PLAIN, HEX	EA	4
4	5	PAHZZ	5310-00-515-8243	30723	96211	WASHER, FLAT	EA	4
4	6	PAHZZ	5340-00-985-6633	ES160-0	20418	CLAMP, LOOP	EA	2
4	7	PAHZZ	5340-00-964-2557	NAS1397P8N	80205	CLAMP, LOOP	EA	1
4	8	PAHZZ	5310-820-7155	F22NCFMA2-26	72962	NUT, PLAIN, HEX	EA	4
4	9	PAHZZ	5930-00-835-4782	255928MF2	76854	SWITCH ROTARY	EA	1
4	10	PAHZZ	5930-00-504-6223	MS25089-4C	96906	SWITCH PUSH	EA	1
4	11	XDHZZ		255909MF3	76854	SWITCH, ROTARY	EA	1
4	12	PAHZZ	5305-00-054-5636	MS51957-2	96906	SCREW, MACHINE	EA	4
4	13	XDHZZ		609-7449-002	13499	PLATE, IDENTIFICATION	EA	1
4	14	PAHZZ	5320--754-0822	MS20470AD4-5	96906	RIVET, SOLID	EA	1
4	15	PAHZZ	5930-00-116-8830	239014K3	76854	SWITCH, ROTARY	EA	1
4	16	XDHZZ		255911MF2	76854	SWITCH, ROTARY	EA	2
4	17	PAHZZ	5340-00-969-6501	NAS139TR7	80205	CLAMP, LOOP	EA	1
4	18	PAHZZ	5940-00-665-5592	4012HTD	77147	TERMINAL, LUG	EA	1
4	19	PAHZZ	5305-00-763-6963	MS51959-28	96906	SCREW, MACHINE	EA	1
4	20	PAHZZ	5310-00-798-4847	FPN6-32SCL	83324	PRESS, NUT, FLOAT TYPE	EA	16
11/(12 blank)								

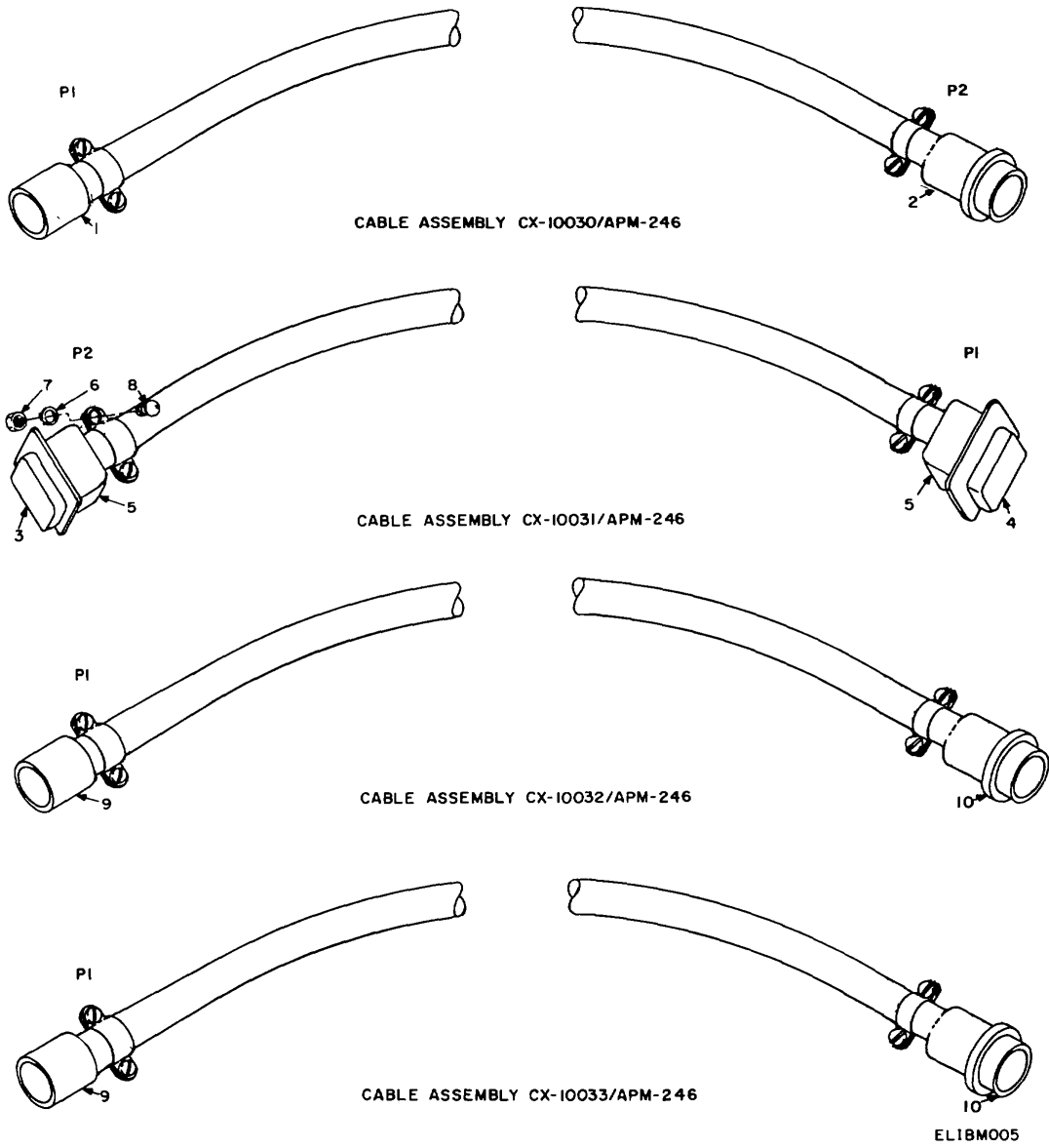

Figure 5. Cable Assemblies for AN/APM-246 (/SGEET 1 OF 2).

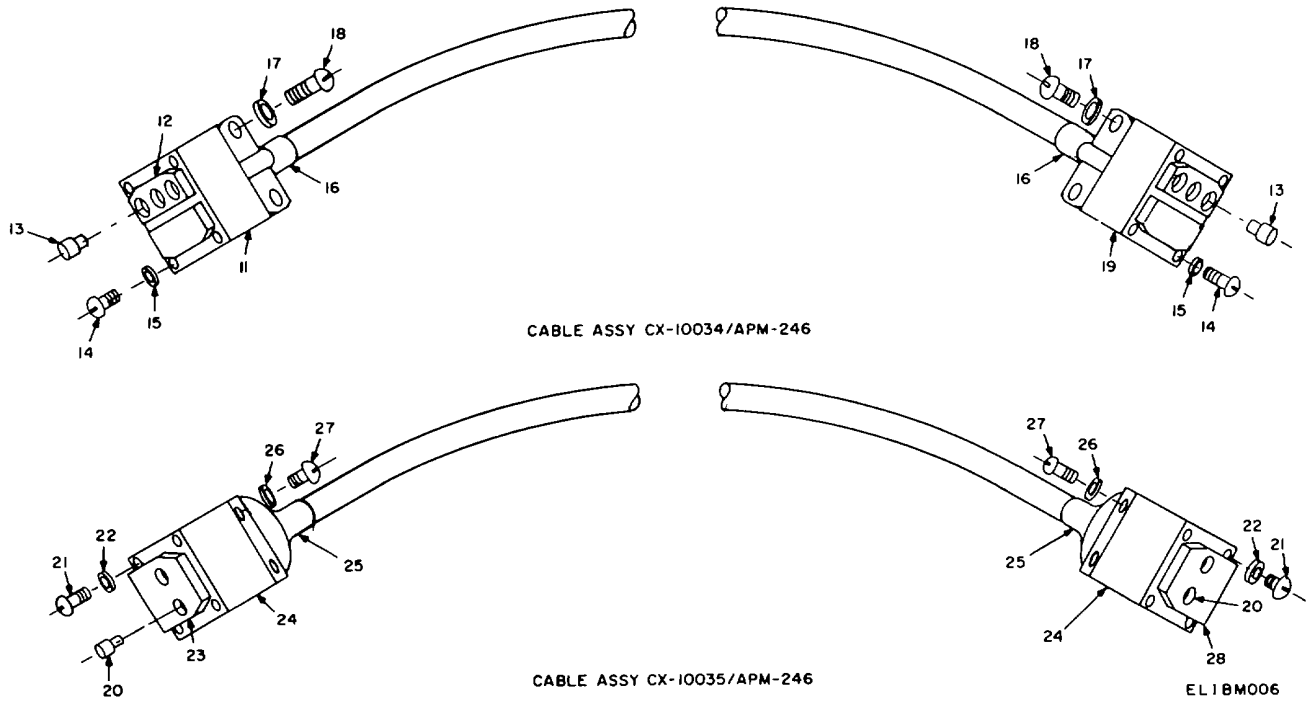

Figure 5, Cable Assemblies for AN/APM-246 (Sheet 2 of 2).

SECTION II REPAIR PARTS LIST (AN/APM-246)

(1) ILLUSTRATION		(2)	(3)	(4)	(5)	(6) DESCRIPTION	(7)	(8)
(a) FIG NO.	(b) ITEM NO.	SMR CODE	NATIONAL STOCK NUMBER	PART NUMBER	FSCM	USABLE ON CODE	U/M	QTY INC IN UNIT
						GROUP: 03 CABLE ASSEMBLIES FOR AN/APM-246		
						GROUP: 0301 CABLE ASSEMBLY, SPECIAL PURPOSE ELECTRICAL CX-10030()/APM-246		
5	1	PAHZZ	5935-00-779-8295	NS3116F14-19S	96906	CONNECTOR, PLUG, ELECTRICAL	EA	1
5	2	PAHZZ	5935-00-841-7227	KPT0iB14-19P	71468	CONNECTOR, PLUG, ELECTRICAL	EA	1
						GROUP: 0302 CABLE ASSEMBLY, SPECIAL PURPOSE ELECTRICAL CX-10031()/APM-246		
5	3	PAHZZ	5935-00-327-9301	DA15SC37	71468	CONNECTOR, RECEPTACLE, ELECTRICAL	EA	1
5	4	PAHZZ	5935-00-064-1870	DA15PC33	71468	CONNECTOR, RECEPTACLE, ELECTRICAL	EA	1
5	5	PAHZZ	5935-00-572-9185	DAJS19678-1	71468	SHELL, JUNCTION	EA	2
5	6	PAHZZ	5310-00-208-3786	NAS671C4	80205	NUT, PLAIN, HEX	EA	2
5	7	PAHZZ	5310-00-933-8118	MS35338-135	96906	WASHER, LOCK	EA	2
5	8	PAHZZ	5305-00-054-5647	MS51957-13	96906	SCREW, MACHINE	EA	2
						GROUP: 0303 CABLE ASSEMBLY, SPECIAL PURPOSE, ELECTRICAL CX-10032()/APN-246		
5	9	PAHZZ	5935-00-717-2591	Ms3116F18-32S	96906	CONNECTOR, PLUG, ELECTRICAL	EA	1
5	10	PAHZZ	5935-00-011-7878	PTO1A18-32PSR	06840	CONNECTOR, PLUG, ELECTRICAL	EA	1
						GROUP: 0304 CABLE ASSEMBLY, SPECIAL PURPOSE, ELECTRICAL CX-10033()/APM-246		
5	9	PAHZZ	5935-00-717-2591	M53116F18-32S	96906	CONNECTOR, PLUG, ELECTRICAL	EA	1
5	10	PAHZZ	5935-00-011-7878	PTO1A18-32PSR	06840	CONNECTOR, PLUG, ELECTRICAL	EA	1
						GROUP: 0305 CABLE ASSEMBLY, SPECIAL PUR- POSE, ELECTRICAL CX-10034()/APM-246		
5	11	PAHZZ	5935-00-839-6714	S138	07418	ADAPTER, CABLE TO CONNECTOR	EA	2
5	12	PAHZZ	5935-00-773-1735	370-2203-00	13499	CONNECTOR ASSEMBLY, ELECTRICAL	EA	1
5	13	XDHZZ		RF6621-23	94375	CONNECTOR, PLUG, ELECTRICAL	EA	6
5	14	PANZZ	5305-00-054-5649	MS51957-15	96906	SCREW, MACHINE	EA	8
5	15	PAHZZ	5310-00-933-8118	6s35338-135	96906	WASHER, LOCK	EA	8
5	16	PAHZZ	5365-00-141-6943	S31420-16	96906	BUSHING, CABLE	EA	2
5	17	PAHZZ	5310-00-933-8121	Ms35338-139	96906	WASHER, LOCK	EA	4
5	18	PABZZ	5305-00-071-2087	Ms51957-84	96906	SCREW, MACHINE	EA	4
5	19	XDHZZ		DPX2416C3P40 P3XA0773	71468	CONNECTOR ASSEMBLY, ELECTRICAL	EA	1
						GROUP: 0306 CABLE ASSEMBLY, SPECIAL PURPOSE, ELECTRICAL CX-10035()/APN-246		
5	20	XDHZZ		RF6621-23	94375	CONNECTOR, PLUG, ELECTRICAL	EA	4
5	21	PAHZZ	5305-00-054-5649	NS51957-15	96906	SCREW, MACHINE	EA	8
5	22	PANZZ	5310-00-933-8118	MS35338-135	96906	WASHER, LOCK	EA	8
5	23	PAHZZ	5935-00-926-3011	DPXG32C2-34P	71468	CONNECTOR, RECEPTACLE, ELECTRICAL	EA	1
5	24	PAHZZ	5935-00-878-1639	S139-3	07418	ADAPTER, CABLE TO CONNECTOR	EA	2
5	25	PAHZZ	5365-00-598-5416	6S342012	96906	BUSHING, CABLE	EA	2
5	26	PAHZZ	5310-00-933-8119	M635338-137	96906	WASHER, LOCK	EA	4
5	27	PAHZZ	5305-00-402-5788	Ms51957-127	96906	SCREW, MACHINE	EA	4
5	28	PAHZZ	5935-00-773-1744	DPX32C2-33S	71468	CONRECTOR ASSEMBLY, ELECTRICAL	EA	1
					15			

SECTION II REPAIR PARTS LIST (AN/APM-246) (CONTINUED)

(1) ILLUSTRATION		(2)	(3)	(4)	(5)	(6) DESCRIPTION	(7)	(8)
(a) FIG NO.	(b) ITEM NO.	SMR CODE	NATIONAL STOCK NUMBER	PART NUMBER	FSCM	USABLE ON CODE	U/M	QTY INC IN UNIT
						GROUP: 04 BULK MATERIAL		
BULK		PAHZZ	6145-00-056-8814	WH65333-01-02-01	50625	WIRE, ELECTRICAL	FT	
BULK		PAHZZ	6145-00-060-9097	WTE734ACW913	90484	WIRE, ELECTRICAL	FT	
BULK		PAHZZ	6145-00-060-9500	WTE734ACW93	90484	WIRE, ELECTRICAL	FT	
BULK		PAHZZ	6145-00-060-9503	WTE734ACW9	90484	WIRE, ELECTRICAL	FT	
BULK		PAHZZ	6145-00-060-9504	WTE734ACW91	90484	WIRE, ELECTRICAL	FT	
BULK		PAHZZ	6145-00-060-9505	WTE734ACW92	90484	WIRE, ELECTRICAL	FT	
BULK		PAHZZ	6145-00-060-9507	WTE734ACW90	90484	WIRE, ELECTRICAL	FT	
BULK		PAHZZ	6145-00-060-9512	WTE734ACW95	90484	WIRE, ELECTRICAL	FT	
BULK		PAHZZ	6145-00-080-3022	WTE734ACW4	90484	WIRE, ELECTRICAL	FT	
BULK		PAHZZ	6145-00-103-0712	WTE734ACW925	90484	WIRE, ELECTRICAL	FT	
BULK		PAHZZ	6145-00-103-0713	WTE734ACW923	90484	WIRE, ELECTRICAL	FT	
BULK		PAHZZ	6145-00-103-0714	WTE734ACW916	90484	WIRE, ELECTRICAL	FT	
BULK		PAHZZ	6145-00-103-0716	WTE734ACW915	90484	WIRE, ELECTRICAL	FT	
BULK		PAHZZ	6145-00-103-0718	WTE734ACW936	90484	WIRE, ELECTRICAL	FT	
BULK		PAHZZ	6145-00-103-0720	WTE734ACW926	90484	WIRE, ELECTRICAL	FT	
BULK		PAHZZ	6145-00-103-3053	WTE734ACW956	90484	WIRE, ELECTRICAL	FT	
BULK		PAHZZ	6145-00-113-3909	WTE734ACW903	90484	WIRE, ELECTRICAL	FT	
BULK		PAHZZ	6145-00-113-3910	WTE734AC906	90484	WIRE, ELECTRICAL	FT	
BULK		PAHZZ	6145-00-113-3911	WTE734ACW905	90184	WIRE, ELECTRICAL	FT	
BULK		PAHZZ	6145-00-113-6278	WTE734ACW912	90484	WIRE, ELECTRICAL	FT	
BULK		PAHZZ	6145-00-147-6413	WTE734CW7	90484	WIRE, ELECTRICAL	FT	
BULK		PAHZZ	6145-00-160-4775	421-2220-000	13499	WIRE, ELECTRICAL	FT	
BULK		PAHZZ	6145-00-199-8068	WH65333-08-04-01	50625	WIRE, ELECTRICAL	FT	
BULK		PAHZZ	6145-00-295-2810	F20WHITE	81349	WIRE, ELECTRICAL	FT	
BULK		PAHZZ	6145-00-548-0969	WTE730A9	90484	WIRE, ELECTRICAL	FT	
BULK		PAHZZ	6145-00-578-6824	WTE730A6	90484	WIRE, ELECTRICAL	FT	
BULK		PAHZZ	6145-00-578-6978	WTE730A8	90484	WIRE, ELECTRICAL	FT	
BULK		PAHZZ	6145-00-581-1616	439-4472-000	13499	WIRE, ELECTRICAL	FT	
BULK		PAHZZ	6145-00-581-1621	439-4296-00	13499	WIRE, ELECTRICAL	FT	
BULK		PAHZZ	6145-00-581-1622	439-4292-00	13499	WIRE, ELECTRICAL	FT	
BULK		PAHZZ	6145-00-581-1623	E20GREEN	81349	WIRE, ELECTRICAL	FT	
BULK		PAHZZ	6145-00-581-1624	XE2072881-3	28581	WIRE, ELECTRICAL	FT	
BULK		PAHZZ	6145-00-581-1625	WTE728A2	90484	WIRE, ELECTRICAL	FT	
BULK		PAHZZ	6145-00-581-1626	439-4297-000	13499	WIRE, ELECTRICAL	FT	
BULK		PAHZZ	6145-00-581-9324	WTE730A1	90484	WIRE, ELECTRICAL	FT	
BULK		PAHZZ	6145-00-623-7225	WTE730A5	90484	WIRE, ELECTRICAL	FT	
BULK		PAHZZ	6145-00-686-4465	WTE734ACW902	90484	WIRE, ELECTRICAL	FT	
BULK		PAHZZ	6145-00-686-4937	WTE730A96	90484	WIRE, ELECTRICAL	FT	
BULK		PAHZZ	6145-00-686-4939	WTE730A93	90484	WIRE, ELECTRICAL	FT	
BULK		PAHZZ	6145-00-686-4940	WTE730A92	90484	WIRE, ELECTRICAL	FT	
BULK		PAHZZ	6145-00-686-4941	WTE730A91	90484	WIRE, ELECTRICAL	FT	
					16			

SECTION II REPAIR PARTS LIST (AN/APM-246) (CONTINUED)

(1) ILLUSTRATION		(2)	(3)	(4)	(5)	(6) DESCRIPTION	(7)	(8)
(a) FIG NO.	(b) ITEM NO.	SMR CODE	NATIONAL STOCK NUMBER	PART NUMBER	FSCM	USABLE ON CODE	U/M	QTY INC IN UNIT
BULK		PAHZZ	6145-00-721-8921	WH65333-09-6-01	50625	WIRE, ELECTRICAL		FT
BULK		PAHZZ	6145-00-754-8057	WTE730A0	90484	WIRE, ELECTRICAL		FT
BULK		PAHZZ	6145-00-754-8058	WTE730A3	90484	WIRE, ELECTRICAL		FT
BULK		PAHZZ	6145-00-822-3473	WTE734ACW1	90484	WIRE, ELECTRICAL		FT
BULK		PAHZZ	6145-00-822-3474	WTE734ACW2	90484	WIRE, ELECTMICAL		FT
BULK		PAHZZ	6145-00-822-3475	WTE734ACW3	90484	WIRE, ELECTRICAL		FT
BULK		PAHZZ	6145-00-822-3481	WTE22A9	90484	WIRE, ELECTRICAL		FT
BULK		PAHZZ	6145-00-822-4033	WTE734ACW0	90484	WIRE, ELECTRICAL		FT
BULK		PAHZZ	6145-00-838-6994	WTE734ACW6	90484	WIRE, ELECTRICAL		FT
BULK		PAHZZ	6145-00-838-6995	WTE734ACW8	90484	WIRE, ELECTRICAL		FT
BULK		PAHZZ	6145-00-838-9446	WTE734ACW5	90484	WIRE, ELECTRICAL		FT
BULK		PAHZZ	6145-00-880-6380	WH65333-01-14-01-02-01	50625	WIRE, ELECTRICAL		FT
BULK		PAHZZ	6145-00-880-6381	WH65333-01-14-01-09-01	50625	WIRE, ELECTRICAL		FT
BULK		PAHZZ	6145-00-880-6382	WH65333-01-14-01-08-01	50625	WIRE, ELECTRICAL		FT
BULK		PAHZZ	6145-00-880-6388	WH65333-01-14-01-04-011	50625	WIRE, ELECTRICAL		FT
BULK		PAHZZ	6145-00-993-8809	WH66817-95	50625	WIRE, ELECTRICAL		FT
BULK		PAHZZ	6145-00-993-8811	WH66817-96	50625	WIRE, ELECTRICAL		FT
BULK		PAHZZ	6145-01-010-5474	WH66817-92	50625	WIRE, ELECTRICAL		FT
BULK		PAHZZ	6145-01-012-3975	WH66817-93	50625	WIRE, ELECTRICAL		FT
BULK		PAHZZ		TX18-1930-0	99114	WIRE, ELECTRICAL		FT
BULK		PAHZZ		WH65333-01-09-01-06-01	50625	WIRE, ELECTRICAL		FT
BULK		PAHZZ		WH66817-90	50625	WIRE, ELECTRICAL		FT
BULK		PAHZZ		XE20728S1-0	28581	WIRE, ELECTRICAL		FT
BULK		PAHZZ		XE20728S1-7	28581	WIRE, ELECTRICAL		FT
BULK		PAHZZ		XE20728S1-8	28581	WIRE, ELECTRICAL		FT
BULK		PAHZZ		XE20728S1-90	28581	WIRE, ELECTRICAL		FT
BULK		PAHZZ		1XT22730-4	12515	WIRE, ELECTRICAL		FT
BULK		PAHZZ		1XT22730-95	12515	WIRE, ELECTRICAL		FT
BULK		PAHZZ		270-3920	99114	WIRE, ELECTRICAL		FT
BULK		PAHZZ		423-0235-000	99114	WIRE, ELECTRICAL		FT
					17			

SECTION IV. NATIONAL STOCK NUMBER AND PART NUMBER INDEX (AN/APM-246)

STOCK NUMBER	FIG. NO.	ITEM NO.	STOCK NUMBER	FIG. NO.	ITEM NO.
5210-00-999-1432	1	3	5935-00-087-8049	3	11
5305-00-054-5636	4	12	5935-00-327-9301	5	3
5305-00-054-5647	5	18	5935-00-572-9185	5	5
5305-00-054-5649	3	7	5935-00-717-2591	5	9
5305-00-054-5649	5	14	5935-00-728-4514	2	1
5305-00-054-5649	5	21	5935-00-773-1735	5	12
5305-00-054-6652	1	8	5935-00-773-1744	5	28
5305-00-054-6652	3	18	5935-00-779-8295	5	1
5305-00-071-2087	5	18	5935-00-827-1336	3	16
5305-00-402-5788	5	27	5935-00-839-6714	5	11
5305-00-619-5475	2	4	5935-00-841-7227	5	2
5305-00-763-6963	4	19	5935-00-878-1639	5	24
5305-00-764-0070	3	2	5935-00-926-3011	3	8
5305-00-765-4257	3	3	5935-00-926-3011	5	23
5307-00-679-4382	2	6	5940-00-665-5592	4	18
5310-00-136-1631	3	6	5995-00-926-0821	1	12
5310-00-208-3786	3	4	5995-00-926-0822	1	13
5310-00-208-3786	5	6	5995-00-926-0823	1	14
5310-00-208-9457	4	4	5995-00-926-0824	1	15
5310-00-515-8243	4	5	5995-00-926-0825	1	11
5310-00-574-9790	1	6	5995-00-926-0826	1	21
5310-00-798-4847	3	17	5999-00-065-1833	3	13
5310-00-798-4847	4	20	6135-00-727-0449	4	1
5310-00-820-7155	4	8	6145-00-056-8814	BULK	
5310-00-933-8118	3	5	6145-00-060-9097	BULK	
5310-00-933-8118	5	7	6145-00-060-9500	BULK	
5310-00-933-8118	5	15	6145-00-060-9503	BULK	
5310-00-933-8118	5	22	6145-00-060-9504	BULK	
5310-00-933-8119	5	26	6145-00-060-9505	BULK	
5310-00-933-8121	5	17	6145-00-060-9507	BULK	
5320-00-117-6816	1	17	6145-00-060-9512	BULK	
5320-00-117-6949	4	2	6145-00-080-3022	BULK	
5320-00-754-0822	1	19	6145-00-103-0712	BULK	
5320-00-754-0822	4	14	6145-00-103-0713	BULK	
5325-00-174-5317	3	15	6145-00-103-0714	BULK	
5340-00-964-2557	4	7	6145-00-103-0716	BULK	
5340-00-969-6501	4	17	6145-00-103-0718	BULK	
5340-00-985-6633	4	6	6145-00-103-0720	BULK	
5355-00-931-1492	2	7	6145-00-103-3053	BULK	
5355-00-931-3429	2	2	6145-00-113-3909	BULK	
5365-00-141-6943	5	16	6145-00-113-3910	BULK	
5365-00-598-5416	5	25	6145-00-113-3911	BULK	
5365-00-950-6456	1	7	6145-00-113-6278	BULK	
5895-00-928-7370	2	3	6145-00-147-6413	BULK	
5930-00-116-8830	4	15	6145-00-160-4775	BULK	
5930-00-504-6223	4	10	6145-00-199-8068	BULK	
5930-0G-835-4782	4	9	6145-00-295-2810	BULK	
5935-00-011-7878	5	10	6145-00-548-0969	BULK	
5935-00-064-1870	3	14	6145-00-578-6824	BULK	
5935-00-064-1870	5	4	6145-00-578-6978	BULK	

SECTION IV. NATIONAL STOCK NUMBER AND PART NUMBER INDEX (AN/APM-6) (CONTINUED)

STOCK NUMBER	FIG. NO.	ITEM NO.	STOCK NUMBER	FIG. NO.	ITEM NO.
6145-00-581-1616	BULK				
6145-00-581-1621	BULK				
6145-00-581-1622	BULK				
6145-00-581-1623	BULK				
6145-00-581-1624	BULK				
6145-00-581-1625	BULK				
6145-00-581-1626	BULK				
6145-00-581-9324	BULK				
6145-00-623-7225	BULK				
6145-00-686-4465	BULK				
6145-00-686-4937	BULK				
6145-00-686-4939	BULK				
6145-00-686-4940	BULK				
6145-00-686-4941	BULK				
6145-00-721-8921	BULK				
6145-00-754-8057	BULK				
6145-00-754-8058	BULK				
6145-00-822-3473	BULK				
6145-00-822-3474	BULK				
6145-00-822-3475	BULK				
6145-00-822-3481	BULK				
6145-00-822-4033	BULK				
6145-00-838-6994	BULK				
6145-00-838-6995	BULK				
6145-00-838-9446	BULK				
6145-00-880-6380	BULK				
6145-00-880-6381	BULK				
6145-00-880-6382	BULK				
6145-00-880-6388	BULK				
6145-00-993-8809	BULK				
6145-00-993-8811	BULK				
6145-01-010-5474	BLLK				
6145-01-012-3975	BULK				
6210-00-542-6882	2	10			
6210-00-923-4466	2	11			
6240-00-155-7857	1	16			
6240-00-155-7857	2	9			
6625-00-926-4402	1	9			
6625-00-943-2058	1	4			
6625-00-943-2067	1	5			

SECTION IV. NATIONAL STOCK NUMBER AND PART NUMBER INDEX (AN/APM-246) (CONTINUED)

PART NUMBER	FSCM	FIG. NO.	ITEM NO.	PART NUMBER	FSCM	FIG. NO.	ITEM NO.
AN565FC8H3	88044	2	4	MS51957-28	96906	3	18
CG3098APH246	80058	1	4	HS51957-84	96906	5	18
CX10030APM246	80058	1	11	HS51959-28	96906	4	19
CX10031APM246	80058	1	12	MS51959-43	96906	3	3
CX10032APM246	80058	1	13	MS51959-46	96906	3	2
CX10033XAM246	80058	1	14	MX6613APM246	80058	1	3
CX10034APM246	80058	1	15	M39024-10-01	81349	2	1
CX10035APm246	80058	1	21	NAS1397P8N	80205	4	7
CY4475APM246	80058	1	5	NAS1397R7	80205	4	17
DAJS19678-1	71468	5	5	NAS671C4	80205	3	4
DA15PC33	71468	3	14	NAS671C4	80205	5	6
DA15PC33	71468	5	4	NAS6-4-12	07886	2	6
DA15SC37	71468	5	3	PT01A18-32PSR	06840	5	10
DPXG32C2-34P	71468	3	8	PT02A18-32P	77820	3	11
DPXG32C2-34P	71468	5	23	P313-0045-000	77250	4	4
DPX2M16C3P40	71468	3	10	RF6621-23	94375	3	9
P3XA0773							
DPX2N16C3P40	71468	5	19	RF6621-23	94375	5	13
P3XA0773							
DPX32C2-33S	71468	5	28	RF6621-23	94375	5	20
ES160-0	20418	4	6	S138	07418	5	11
E20GREEN	81349	BULK		S139-3	07418	5	24
FPN6-32SCL	83324	3	17	TS2154APM246	80058	1	9
FPN6-32SCL	83324	4	20	TX18-1930-0	99114	BULK	
F20WHITE	81349	BULK		WH65333-01-02-01	50625	BULK	
F22NCFMA2-26	72962	4	8	WH65333-01-09-01-			
KPT01B14-19P	71468	5	2	06-01	50625	BULK	
MS20426AD4-4	96906	4	2	WH65333-01-14-01-			
MS20470AD3-5	96906	1	17	02-01	50625	BULK	
MS20470AD4-5	96906	1	19	WH65333-01-14-01-			
MS20470AD4-5	96906	4	14	04-01	50625	BULK	
MS25089-4C	96906	4	10	WH65333-01-14-01-			
MS25237-328	96906	1	16	08-01	50625	BULK	
MS25237-328	96906	2	9	WH65333-01-14-01-			
MS3116F14-19S	96906	5	1	09-01	50625	BULK	
MS3116F18-32S	96906	5	9	WH65333-08-04-01	50625	BULK	
MS3420-12	96906	5	25	WH65333-09-06-01	50625	BULK	
MS3420-16	96906	5	16	WH66817-90	50625	BULK	
MS35338-135	96906	3	5	WH66817-92	50625	BULK	
M135338-135	96906	5	7	WH66817-93	50625	BULK	
MS35338-135	96906	5	15	WH66817-95	50625	BULK	
MS35338-135	96906	5	22	WH66817-96	50625	BULK	
MS35338-137	96906	5	26	WTE22A9	90484	BULK	
MS35338-139	96906	5	17	WTE728A2	90484	BULK	
MS35489-4	96906	3	15	WTE730AO	90484	BULK	
MS51957-127	96906	5	27	WTE730A1	90484	BULK	
MS51957-13	96906	5	8	WTE730A3	90484	BULK	
MS51957-15	96906	3	7	WTE730A5	90484	BULK	
MS51957-15	96906	5	14	WTE730A6	90484	BULK	
MS51957-15	96906	5	21	WTE730A8	90484	BULK	
MS51957-2	96906	4	12	WTE730A9	90484	BULK	
MS51957-28	96906	1	8	WTE730A91	90484	BULK	

SECTION IV. NATIONAL STOCK NUMBER AND PART NUMBER INDEX (AN/APM 246) (CONTINUED)

PART NUMBER	FSCM	FIG. NO.	ITEM NO.	PART NUMBER	FSCM	FIG. NO.	ITEM NO.
WTE730A92	90484	BULK		1421-2220-000	13499	BULK	
WTE730A93	90484	BULK		423-0235-000	99114	BULK	
WTE730A96	90484	BULK		439-4292-00	13499	BULK	
WTE734ACW0	90484	BULK		439-4296-00	13499	BULK	
WTE734ACW1	90484	BULK		439-4297-000	13499	BULK	
WTE734ACW2	90484	BULK		439-4472-000	13499	BULK	
WTE734ACW3	90484	BULK		516-3498-030	13499	2	5
WTE734ACW4	90484	BULK		541-6017-002	13499	1	7
WTE734ACW5	90484	BULK		556-3012-0029	13499	4	3
WTE734ACW6	90484	BULK		556-3012-015	13499	3	12
WTE734ACW8	90484	BULK		6P6	87034	2	11
WTE734ACW9	90484	BULK		609-7447-002	13499	1	18
WTE734ACW90	90484	BULK		609-7448-002	13499	1	20
WTE734ACW902	90484	BULK		609-7449-002	13499	4	13
WTE734ACW903	90484	BULK		757-0220-002	13499	2	3
WTE734ACW905	90484	BULK		757-0228-002	13499	2	7
WTE734ACW91	90484	BULK		757-0230-002	13499	2	2
WTE734ACW912	90484	BULK		764-8528-001	13499	3	1
WTE734ACW913	90484	BULK		764-8529-001	13499	1	10
WTE734ACW915	90484	BULK		764-8614-001	13499	1	2
WTE734ACW916	90484	BULK		769-7059-001	13499	1	1
WTE734ACW92	90484	BULK		8P6	87034	2	8
WTE734ACW923	90484	BULK		8461219	19203	1	6
WTE734ACW925	90484	BULK		85	76545	3	13
WTE734ACW926	90484	BULK					
WTE734ACW93	90484	BULK					
WTE734ACW936	90484	BULK					
WTE734ACW95	90484	BULK					
WTE734ACW956	90484	BULK					
WTE734AC906	90484	BULK					
WTE734CW7	90484	BULK					
XE20728S1-0	28581	BULK					
XE20728S1-3	28581	BULK					
XE20728S1-7	28581	BULK					
XE20728S1-8	28581	BULK					
XE20728S1-90	28581	BULK					
1XT22730-4	12515	BULK					
1XT22730-95	12515	BULK					
14-30380	87034	2	10				
2175	91833	4	1				
239014K3	76854	4	15				
255909MF3	76854	4	11				
255911MF2	76854	4	16				
255928MF2	76854	4	9				
270-3920	99114	BULK					
30723	96214	4	5				
310-6340-000	79807	3	6				
370-2203-00	13499	5	12				
371-2051-000	13499	3	16				
4012HTD	77147	4	18				

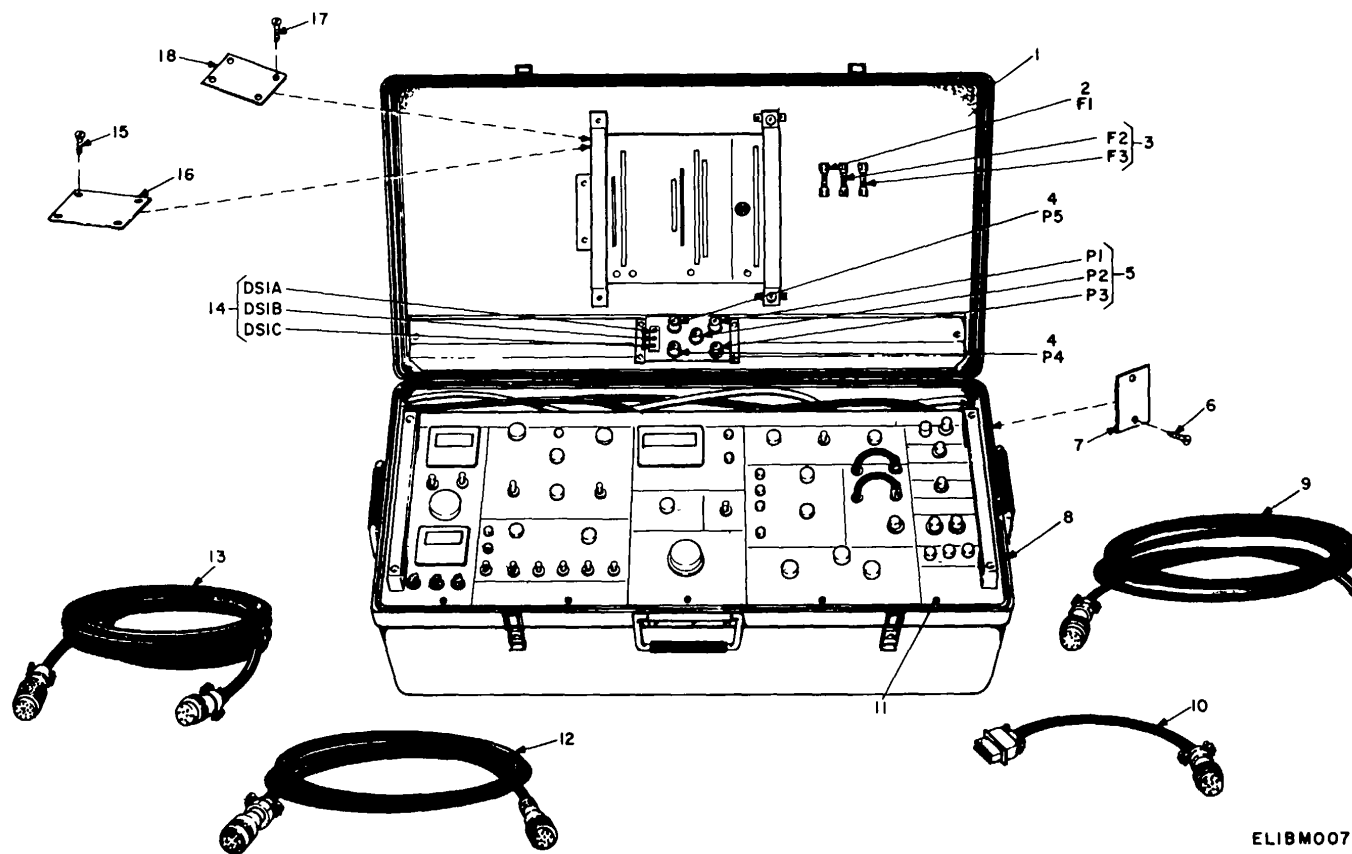

ELIBM007

Figure 6. Test Set, Radar AN/APM-247.

SECTION V REPAIR PARTS LIST (AN/APM-247)

(1) ILLUSTRATION		(2)	(3)	(4)	(5)	(6) DESCRIPTION	(7)	(8)
(a) FIG NO.	(b) ITEM NO.	SMR CODE	NATIONAL STOCK NUMBER	PART NUMBER	FSCM	USABLE ON CODE	U/M	QTY INC IN UNIT
						GROUP: 00 TEST SET. RADAR AN/APM-247		
6	1	PDHHD	6625-00-132-3748	CW752APM247	80058	COVER, TEST SET	EA	1
6	2	PAOZZ	5920-00-280-4465	F02A250V1AS	81349	FUSE, CARTRIDGE	EA	1
6	3	PAOZZ	5920-00-474-6125	F02A250V2AS	81349	FUSE, CASTRIDGE	EA	2
6	4	PAHZZ	5935-00-259-0205	UG201AU	80058	ADAPTER, CONNECTOR, ELECTRICAL	EA	2
6	5	PAHZZ	5935-00-149-3534	UG273U	80058	ADAPTER, CONNECTOR, ELECTRICAL	EA	3
6	6	PAHZZ	5305-00-054-5644	MS51957-11	96906	SCREW, MACHINE	EA	2
6	7	XDHZZ		766-0530-008	13499	PLATE, IDENTIFICATION	EA	1
6	8	PDHHD	6625-00-926-4403	TS2081APM247	80058	TEST SET, RADAR	EA	1
6	9	PAOHH	5995-00-926-0820	CX10029APM247	80058	CABLE ASSEMBLY, SPECIAL PURPOSE	EA	1
6	10	PAOHH	5995-00-926-3330	CX11555APM247	80058	CABLE ASSEMBLY, SPECIAL PURPOSE	EA	1
6	11	XDHZZ		516-3498-033	13499	SCREW, MACHINE, MODIFIED	EA	1
6	12	PAOHH	5995-00-931-1047	CG-1466U4FT	80058	CABLE ASSEMBLY, SPECIAL PURPOSE	EA	1
6	13	PAOHH	5995-00-933-5385	CX10242APM247	80058	CABLE ASSEMBLY. SPECIAL PURPOSE	EA	1
6	14	PAOZZ	6240-00-155-7857	MS25237-328	96906	LAMP, INCANDESCENT	EA	3
6	15	PAHZZ	5320-00-117-6949	MS20426AD4-4	96906	RIVET, SOLID	EA	2
6	16	XDHZZ		766-0530-001	13499	PLATE, IDENTIFICATION	EA	1
6	17	XDHZZ		MS20426AD3-4	96906	RIVET, SOLID	EA	4
6	18	XDHZZ		766-0529-001	13499	PLATE, IDENTIFICATION	EA	1
23/(24 blank)								

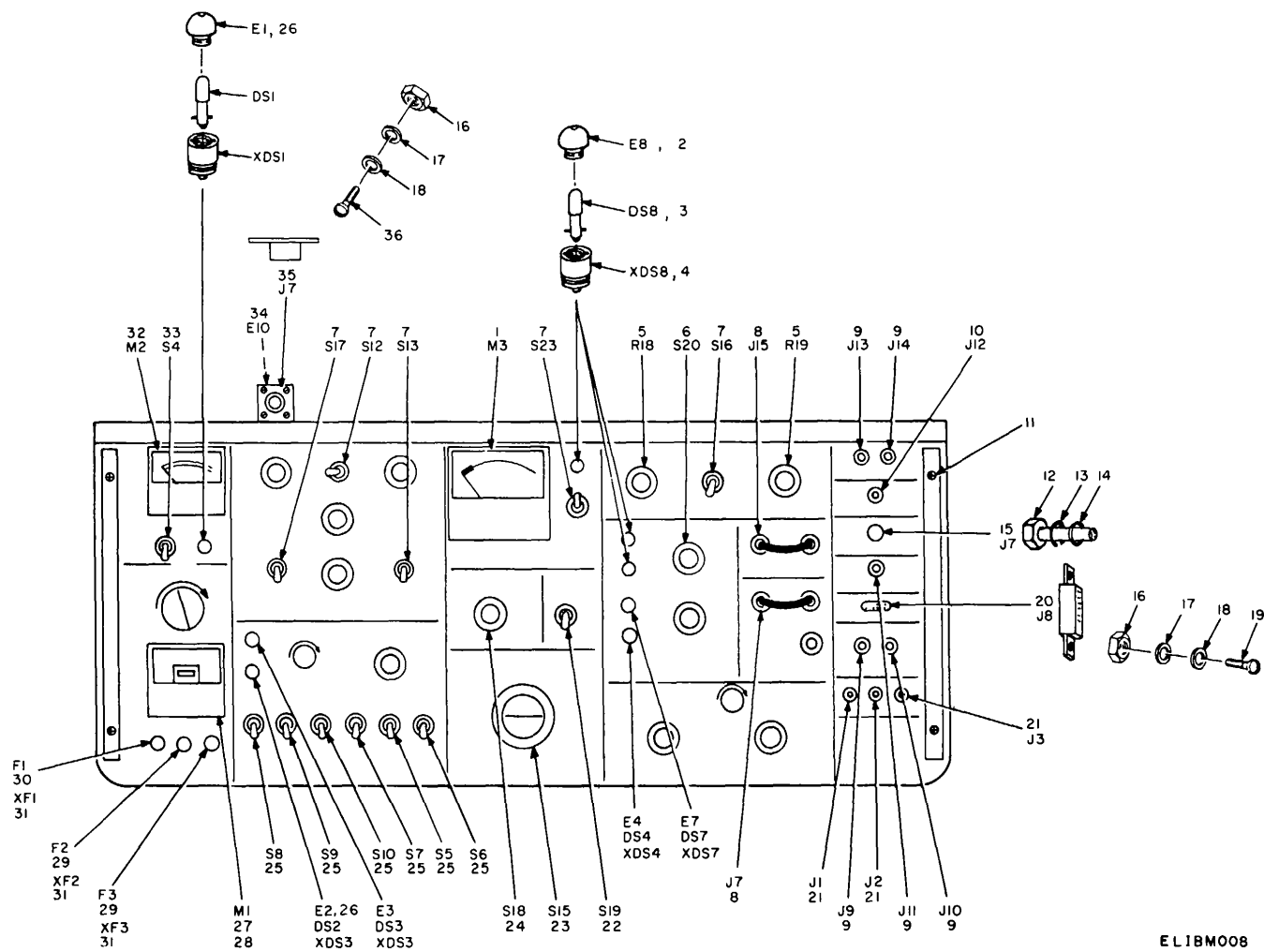

Figure 7. Test Set, Radar TS-2081 ()/APM-247, front (Sheet 1 of 2).

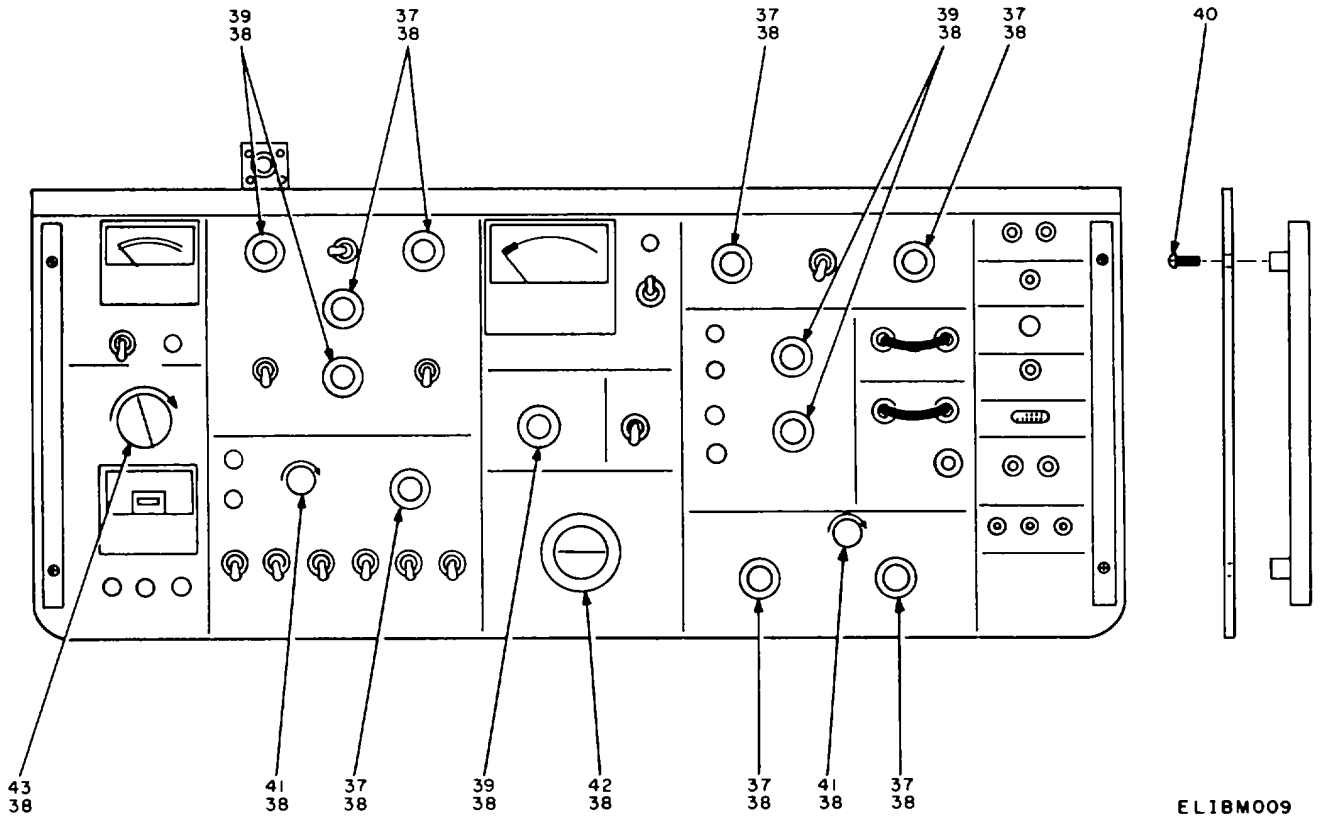

Figure 7. Test Set, Radar TS-2081 ()/APM-247, front (sheet 2 of 2).

SECTION V REPAIR PARTS LIST (AN/APM-247) (CONTINUED)

(1) ILLUSTRATION		(2)	(3)	(4)	(5)	(6) DESCRIPTION	(7)	(8)
(a) FIG NO.	(b) ITEM NO.	SMR CODE	NATIONAL STOCK NUMBER	PART NUMBER	FSCM	USABLE ON CODE	U/M	QTY INC IN UNIT
						GROUP: 01 TEST SET, RADAR TS-2081()/ APM-247		
7	1	PAHZZ	6625-00-998-0061	329-13219	77221	AMMETER, DC	EA	1
7	2	PAOZZ	6210-00-923-4467	8P6	87034	LENS, INDICATOR, LIGHT	EA	6
7	3	PAOZZ	6240-00-155-7857	MS25237-328	96906	LAMP, INCANDESCENT	EA	8
7	4	PAHZZ	6210-00-542-6882	14-30380	87034	LIGHT, INDICATOR	EA	8
7	5	PAHZZ	5905-00-993-8349	RV4NAYSD251A	61349	RESISTOR, VARIABLE	EA	2
7	6	PAHZZ	5930-00-116-8707	PA600-580	71590	SWITCH, ROTARY	EA	5
7	7	PAHZZ	5930-00-834-6264	82989S	04009	SWITCH, TOGGLE	EA	5
7	8	PAHZZ	5935-00-836-6522	UG910CU	80058	CONNECTOR, JACK, ELECTRICAL	EA	3
7	9	PAHZZ	5940-00-269-2219	PB01FA01	81349	POST, BINDING	EA	5
7	10	PAHZZ	5940-00-269-2220	PB01FA03	81349	POST, BINDING	EA	1
7	11	PAHZZ	5305-00-764-0070	MS51959-46	96906	SCREW, MACHINE	EA	4
7	12	PAHZZ	5310-00-800-5281	334-0260-00	13499	NUT, PLAIN, HEX	EA	1
7	13	PAHZZ	5310-01-014-5499	1924-02NP	78189	WASHER, LOCK	EA	1
7	14	PAHZZ	5999-00-531-5212	126-1069	32660	RING, COUPLING, FIXED	EA	1
7	15	PAHZZ	5935-00-960-3174	372-1536-000	13499	CONNECTOR, RECEPTACLE, ELECTRICAL	EA	1
7	16	PAHZZ	5310-00-208-3786	NAS671C4	30205	NUT, PLAIN, HEX	EA	6
7	17	PAHZZ	5310-00-933-8118	MS35338-135	96906	WASHER, LOCK	EA	6
7	18	PAHZZ	5310-00-136-1631	310-6340-000	19807	WASHER, FLAT	EA	6
7	19	PAHZZ	5305-00-770-2580	NAS51959-16	96906	SCREW, MACHINE	EA	2
7	20	PAHZZ	5935-00-933-1382	0A15S	1468	CONNECTOR, RECEPTACLE, ELECTRICAL	EA	1
7	21	PAHZZ	5935-00-835-0510	M39012/21-001	31349	CONNECTOR, RECEPTACLE, ELECTRICAL	EA	3
7	22	PAHZZ	5930-00-685-9520	35059K	04009	SWITCH, TOGGLE	EA	1
7	23	XDHZZ		255990K6	76854	SWITCH, ROTARY	EA	1
7	24	PAHZZ	6930-00-937-2913	PA600-582	71590	SWITCH, ROTARY	EA	1
7	25	XDHZZ		32984S	04009	SWITCH, TOGGLE	EA	6
7	26	PAOZZ	6210-00-923-4466	6P6	37034	LENS, INDICATOR, LIGHT	EA	2
7	27	PAHZZ	6625-00-935-1368	290-13220	77221	METER, ELECTRICAL, FREQUENCY	EA	1
7	28	PAHZZ	5310-00-543-2740	MS35333-74	96906	WASHER, LOCK	EA	2
7	29	PAOZZ	5920-00-474-6125	F02A250V2AS	31349	FUSE, CARTRIDGE	EA	2
7	30	PAOZZ	5920-00-280-4465	F02A250V1AS	31349	FUSE, CARTRIDGE	EA	1
7	31	PAHZZ	5920-00-864-6622	HKPH	71400	FUSEHOLDER, RECEPTACLE	EA	3
7	32	PAHZZ	6625-00-997-6245	250-13283	17221	VOLTMETER, ELECTRONIC	EA	1
7	33	PAHZZ	5930-00-852-6681	7665K4MOD	15605	SWITCH, TOGGLE	EA	1
7	34	PAHZZ	5940-00-451-5922	2104-04-01-2520N	78189	TERMINAL, LUG	EA	1
7	35	PAHZZ	5935-00-726-0708	MS3102R10SL3P	96906	CONNECTOR, RECEPTACLE, ELECTRICAL	EA	1
7	36	PAHZZ	5305-00-054-5651	MS51957-17	96906	SCREW, MACHINE	EA	4
7	37	PAOZZ	5355-00-767-5008	757-0233-001	13499	KNOB	EA	7
7	38	PAOZZ	5305-00-719-5342	MS51963-34	96906	SETSCREW	EA	27
7	39	XDOZZ		757-0233-005	13499	KIOB	EA	5
7	40	PAHZZ	5305-00-765-4257	MS51959-43	96906	SCREW, MACHINE	EA	4
					27			

SECTION V REPAIR PARTS LIST (AN/APM-247) (CONTINUED)

(1) ILLUSTRATION		(2)	(3)	(4)	(5)	(6) DESCRIPTION	(7)	(8)
(a) FIG NO.	(b) ITEM NO.	SMR CODE	NATIONAL STOCK NUMBER	PART NUMBER	FSCM	USABLE ON CODE	UM	QTY INC IN UNIT
7	41	XDOZZ		757-0232-002	13499	KNOB	EA	2
7	42	PAOZ	5355-00-941-6758	757-023-004	13499	KNOB	EA	1
7	43	XDOZZ		757-0232-004	13499	KNOB	EA	1

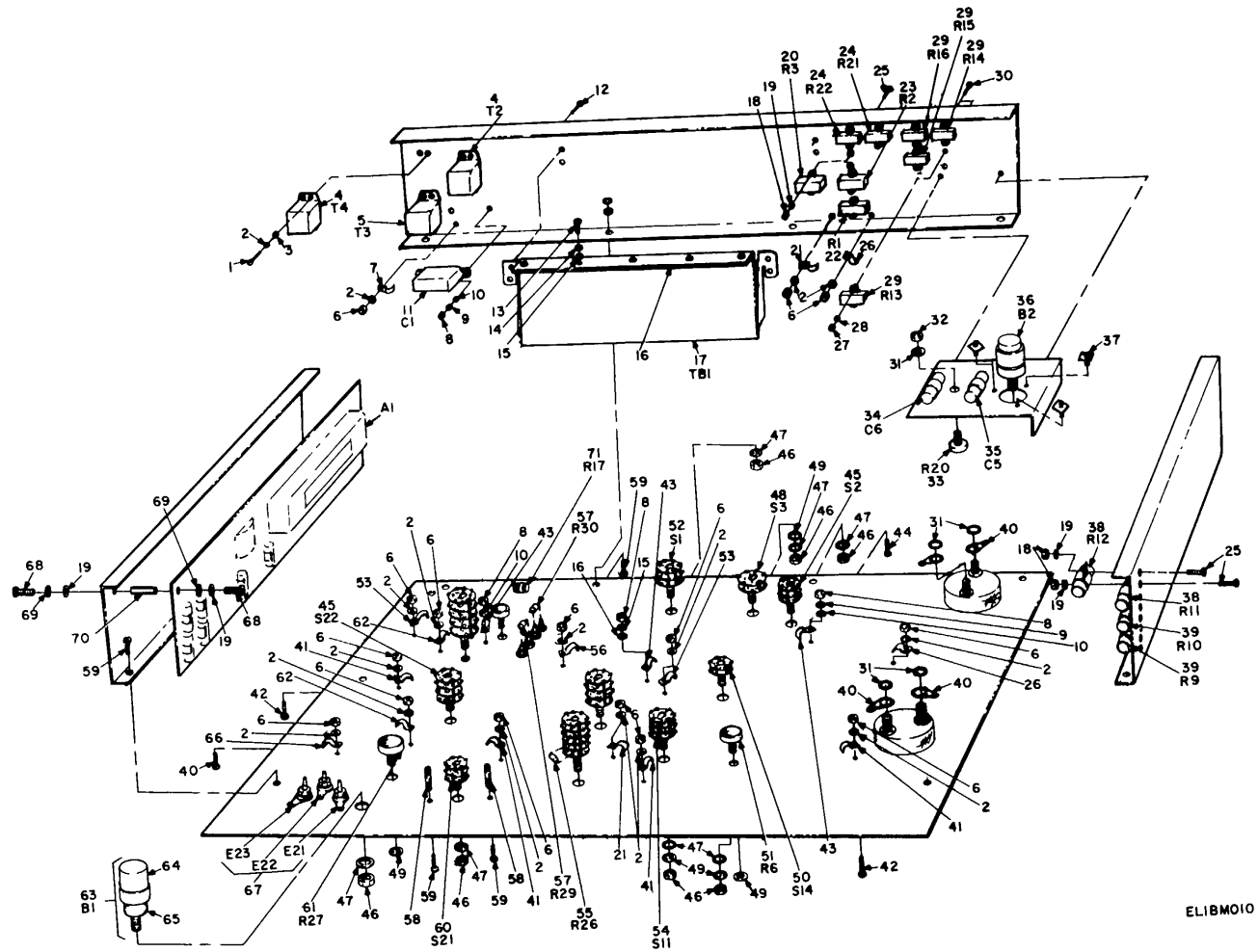

ELIBMOIO

Figure 8. Test Set, Radar TS-2081 ()/APM-247, internal view.

SECTION V. REPAIR PARTS LIST (AN/APM-247) (CONTINUED)

(1) ILLUSTRATION		(2)	(3)	(4)	(5)	(6) DESCRIPTION	(7)	(8)
(a) FIG NO.	(b) ITEM NO.	SMR CODE	NATIONAL STOCK NUMBER	PART NUMBER	FSCM	USABLE ON CODE	U/M	QTY INC IN UNIT
8	1	PAHZZ	5305-00-054-6651	8551957-27	96906	SCREW, MACHINE	EA	12
8	2	PAHZZ	5310-00-515-8243	30723	96214	WASHER, FLAT	EA	27
8	3	PAHZZ	5310-00-929-6395	MS35338-136	96906	WASHER, LOCK	EA	12
8	4	PAHZZ	5950-00-907-8302	76-009370	95105	TRANSFORMER, POWER	EA	2
8	5	PAHZZ	5950-00-778-8624	A12429	70674	TRANSFORMER, POWER	EA	1
8	6	PAHZZ	5310-00-208-9457	278146	56232	NUT, PLAIN, HEX	EA	14
8	7	PATZZ	5340-00-275-6633	ES160-0	20418	CLAMP, LOOP	EA	1
8	8	PAHZZ	5310-00-934-9759	MS35649-284	96906	NUT, PLAIN, HEX	EA	5
8	9	PAHZZ	5310-00-933-8119	MS35338-137	96906	WASHER, LOCK	EA	5
8	10	PAHZZ	5310-00-209-1074	310-0048-000	79807	WASHER, FLAT	EA	5
8	11	PAHZZ	5910-00-112-7312	CP53B1EG254K1	81349	CAPACITOR, FIXED, PAPER DIELECTRIC	EA	1
8	12	PAHZZ	5305-00-054-6668	MS51957-43	96906	SCREW, MACHINE	EA	5
8	13	PAZZ	5305-00-059-3658	MS1958-62	96906	SCREW, MACHINE	EA	5
8	14	PAHZZ	5310-00-933-8120	310-0073-000	79807	WASHER, LOCK	EA	5
8	15	PAHZZ	5310-00-685-1450	310-0049-000	79807	WASHER, FLAT	EA	1
8	16	XDHZZ		764-8590-001	13499	BAR, MOUNTING	EA	1
8	17	PAHZZ	5940-00-143-4704	203343-000	12436	TERMINAL BOARD	EA	1
8	18	PAHZZ	5310-00-208-3786	NAS67IC4	80205	NUT, PLAIN, HEX	EA	17
8	19	PAHZZ	5310-00-933-8118	MS35338-135	96906	WASHER, LOCK	EA	26
8	20	PAHZZ	5905-00-878-7168	RH25X00K50R00F	91637	RESISTOR, FIXED, WIRE WOUND	EA	1
8	21	PAHZZ	5340-00-559-8846	HP11N	09922	CLAMP, LOOP	EA	2
8	22	PAHZZ	5905-00814-0428	RH25	91637	RESISTOR, FIXED, WIREWOUND	EA	1
8	23	XDHZZ		RH25X000D100 R0H	91637	RESISTOR, FIXED, WIREWOUND	EA	1
8	24	PAHZZ	5905-00-958-6715	RE65G1210	81349	RESISTOR, FIXED, WIREWOUND	EA	2
8	25	PATZZ	5305-00-054-5649	MS51957-15	96906	SCREW, MACHINE	EA	16
8	26	PAHZZ	5340-00-964-2555	NAS1397P6N	80205	CLAMP, LOOP	EA	2
8	27	PAHZZ	5310-00-938-2013	MS35649-224	96906	NUT, PLAIN, HEX	EA	12
8	28	PAHZZ	5310-00-928-2690	MS35338-134	96906	WASHER, LOCK	EA	12
8	29	PATZZ	5905-00-119-3068	RH10X000D20 R00B	91637	RESISTOR, FIXED, WIREWOUND	EA	4
8	30	PAHZZ	5305-00-054-5639	MS51957-5	96906	SCREW, MACHINE	EA	12
8	31	PAHZZ	5310-00-543-2740	MS35333-74	96906	WASHER, LOCK	EA	5
8	32	PATZZ	5310-00-240-6445	SMB504565	80063	NUT, PLAIN, HEX	EA	1
8	33	PAHZZ	5905-00-539-5000	RV5NAYS251A	81349	RESISTOR, VARIABLE	EA	1
8	34	PAHZZ	5910-00-649-1858	SDB1K01274J	53021	CAPACITOR, FIXED, PAPER DIELECTRIC	EA	1
8	35	PAHZZ	5910-00-553-6413	931-5000-00	13499	CAPACITOR, FIXED, PAPER DIELECTRIC	EA	1
8	35	PAHZZ	5910-00-617-3246	CP09ALKC333K3	81349	CAPACITOR, FIXED, PAPER DIELECTRIC OR	EA	1
8	35	PAHZZ	5910-00-822-3150	931-4530-00	13499	CAPACITOR, FIXED, PAPER DIELECTRIC OR	EA	1
8	35	PAHZZ	5910-00-773-7984	SDB1K03124K	53021	CAPACITOR, FIXED, PAPER DIELECTRIC OR	EA	1
8	35	PAHZZ	5910-00-649-0544	196P15493S4	56289	CAPACITOR, FIXED, PAPER DIELECTRIC	EA	1
8	36	PAHZZ	5990-00-965-0495	CS11B2A372	86197	RESOLVER, SYNCRO	EA	1
8	37	PAHZZ	5340-00-787-8674	106064-337	06773	CLAMP, RIM, CLENCHING	EA	3
8	38	XDHZZ		RH-50-11R00G	91637	RESISTOR, FIXED, WIRED	EA	2
8	39	PAHZZ	5905-00-882-1545	RE75G20R0	81349	RESISTOR, FIXED, WIREWOUND	EA	2

SECTION V. REPAIR PARTS LIST (AN/APM-247) (CONTINUED)

(1) ILLUSTRATION		(2)	(3)	(4)	(5)	(6) DESCRIPTION	(7)	(8)
(a) FIG NO.	(b) ITEM NO.	SMR CODE	NATIONAL STOCK NUMBER	PART NUMBER	FSCM	USABLE ON CODE	U/M	QTY INC IN UNIT
8	40	PAHZZ	5940-00-501-8634	4021	77147	TERMINAL, LUG	EA	4
8	41	PAHZZ	5340-00-782-8737	NAS1397P4N	80205	CLAMP, LOOP	EA	4
8	42	PABZZ	5305-00-054-6652	MS51957-28	96906	SCREW, MACHINE	EA	3
8	43	PAHZZ	5340-00_664-6732	HP14N	09922	CLAMP, LOOP	EA	3
8	44	PAHZZ	5305-00-054-6669	MS51957-44	96906	SCREW, MACHINE	EA	3
8	45	XDHZZ		78959H3	76854	SWITCH, ROTARY	EA	2
a	46	PAHZZ	5310-00-263-8462	313-0064-00	13499	NUT, PLAIN, HEX	EA	7
8	47	PAHZZ	5310-00-883-5931	8191321	18876	WASHER, LOCK	EA	7
8	48	PAHZZ	5930-00-116-8711	197794K8	76854	SWITCH, ROTARY	EA	1
8	49	PA-ZZ	5310-00-245-4719	310-0052-000	79807	WASHER, FLAT	EA	8
8	50	PABZZ	5930-00-314-3840	159344K1	76854	SWITCH, ROTARY	EA	1
8	51	PANZZ	5905-00-539-4900	RV4NAYS503A	81349	RESISTOR, VARIABLE	EA	1
8	52	PA-ZZ	5930-00-872-0565	237966K2	76854	SWITCH, ROTARY	EA	1
8	53	PA-ZZ	5340-00-964-2557	NAS1397P8N	80205	CLAMP, LOOP	EA	2
8	54	PAHZZ	5930-00-627-4018	259-0852-00	13499	SWITCH, ROTARY	EA	1
8	55	PA-ZZ	5905-00-141-0593	RCR20G182JS	81349	RESISTOR, FIXED, COMPOSITION	EA	1
8	56	PAHZZ	5340-00-619-7754	HP3N	09922	CLAMP, LOOP	EA	1
8	57	PAHZZ	5905-00-104-5755	RCR20G100JS	81349	RESISTOR, FIXED, COMPOSITION	EA	2
8	58	PAHZZ	5340-00-945-1027	540-9464-003	13499	POST, ELECTRICAL	EA	2
8	59	XDHZZ		516-3498-030	13499	SCREW, MACHINE, MODIFIED	EA	13
8	60	PAHZZ	5930-00-927-7312	204324F1	76854	SWITCH, ROTARY	EA	1
8	61	PAHZZ	5905-00-539-5013	RV4RAYSD252A	81349	RESISTOR, VARIABLE	EA	1
8	62	PAHZZ	5340-00-969-6501	NAS1397R7	80205	CLAMP, LOOP	EA	2
8	63	PAHHD	5990-00-774-6295	563-5048-002	13499	SYNCRO ASSEMBLY	EA	1
8	64	PAHZZ	5990-00-715-6695	011-378	99743	SYNCRO CONTROL TRANSFORMER	EA	1
8	65	XAHHD		563-5049-002	13499	GEAR HEAD, SYNCRO	EA	1
8	66	PAHZZ	5340-00-969-6502	NAS1297R5	80205	CLAMP, LOOP	EA	1
8	67	PAHZZ	5940-00-903-5951	0167-3	94375	TERMINAL, LUG	EA	3
8	68	PAHZZ	5305-00-054-5647	MS51957-13	96906	SCREW, MACHINE	EA	12
8	69	PAHZZ	5310-00-136-1631	310-6340-000	79807	WASHER, FLAT	EA	14
8	70	PAHZZ	5340-00-855-3230	540-9176-003	13499	POST, HEXAGON	EA	6
8	71	PAHZZ	5905-00-088-2298	RN65D1470F	81349	RESISTOR, FIXED, FILM	EA	1
8	71	PAHZZ	5905-00-088-3354	RN65D1620F	81349	RESISTOR, FIXED, FILM OR	EA	1
8	71	PAHZZ	5905-00-179-6375	RNC65K1960FS	81349	RESISTOR, FIXED, FILM OR	EA	1
8	71	PAHZZ	5905-00-993-6974	RN65D1780F	81349	RESISTOR, FIXED, FILM OR	EA	1

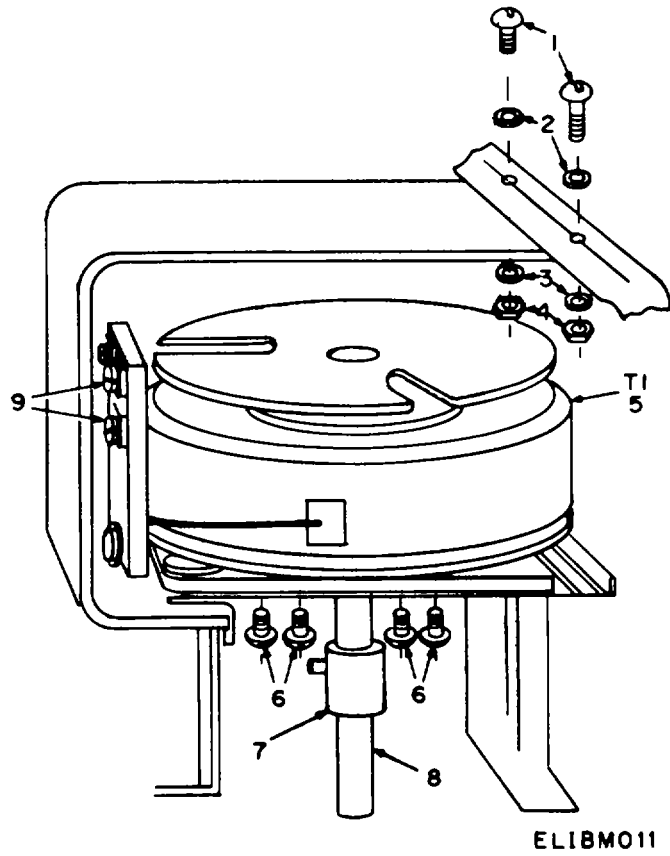

Figure 9. Variable transformer.

SECTION V REPAIR PARTS LIST (AN/APM-247) (CONTINUED)

(1) ILLUSTRATION		(2)	(3)	(4)	(5)	(6) DESCRIPTION	(7)	(8)
(a) FIG NO.	(b) ITEM NO.	SMR CODE	NATIONAL STOCK NUMBER	PART NUMBER	FSCM	USABLE ON CODE	U/M	QTY INC IN UNIT
9	1	PAHZZ	5305-00-763-6963	MS51959-28	96906	SCREW, MACHINE	EA	2
9	2	PAHZZ	5310-00-515-8243	30723	96214	WASHER, FLAT	EA	2
9	3	PAHZZ	5310-00-929-6395	MS35338-136	96906	WASHER, LOCK	EA	2
9	4	PAHZZ	5310-00-208-9457	278146	56232	NUT, PLAIN, HEX	EA	2
9	5	PAHZZ	5950-00-903-3386	116-1199	58474	TRANSFORMER, VARIABLE, POWER	EA	1
9	6	XDHZZ		516-3498-030	13499	SCREW, MACHINE, MODIFIED	EA	4
9	7	PAHZZ	3010-00-937-6448	01-150	23266	COUPLING, SHAFT, RIGID	EA	1
9	8	XDHZZ		764-8581-001	13499	EXTENSION, SHAFT	EA	1
9	9	PAHZZ	5305-00-050-9226	MS51957-60	96906	SCREW, MACHINE	EA	2

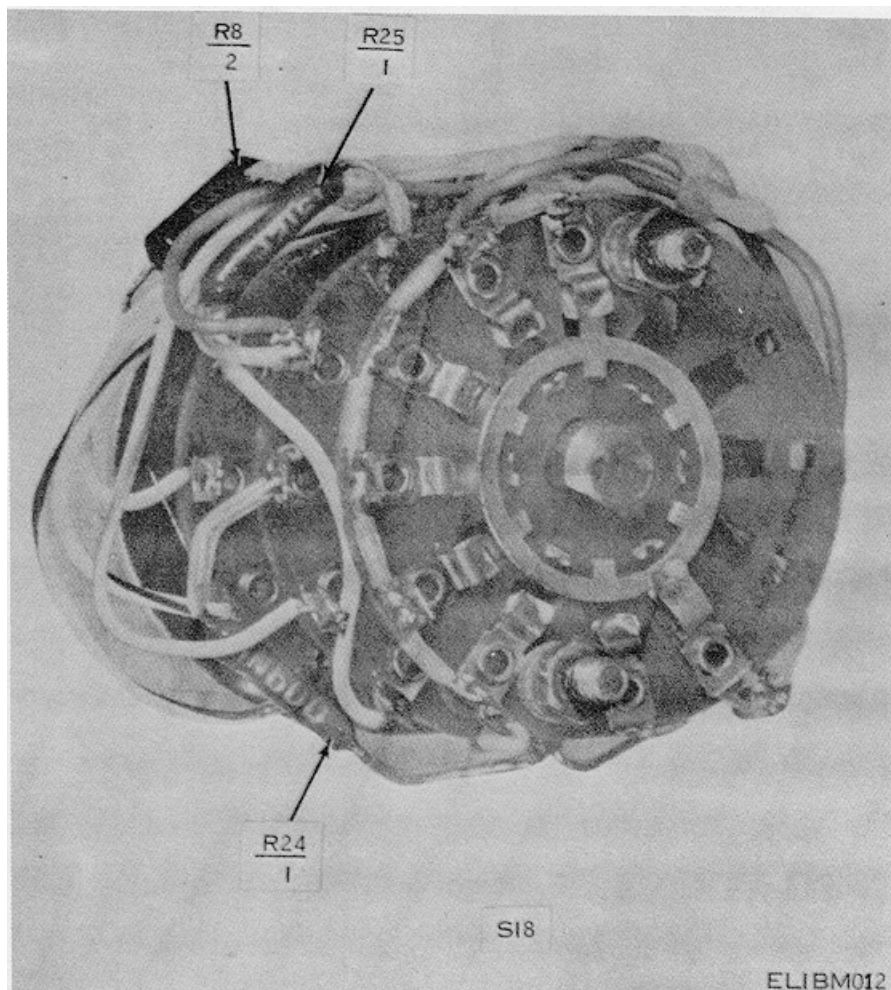

Figure 10. Switch assemblies (Sheet 1 of 4)

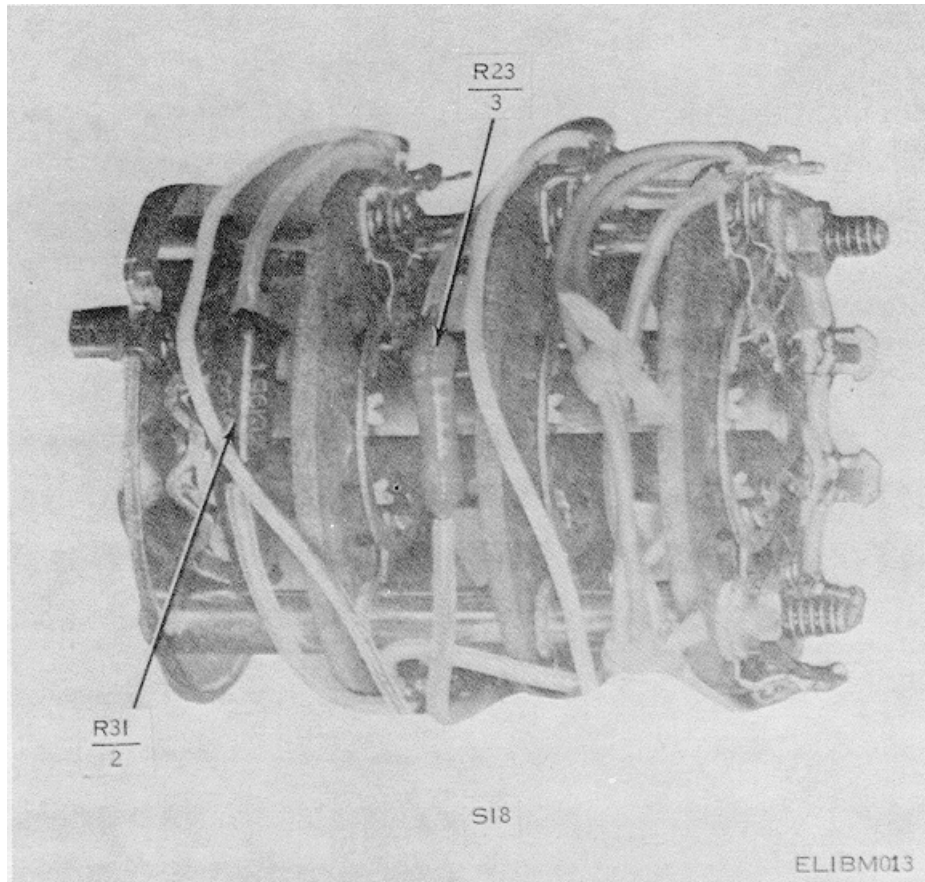

Figure 10. Switch assemblies (Sheet 2 of 4).

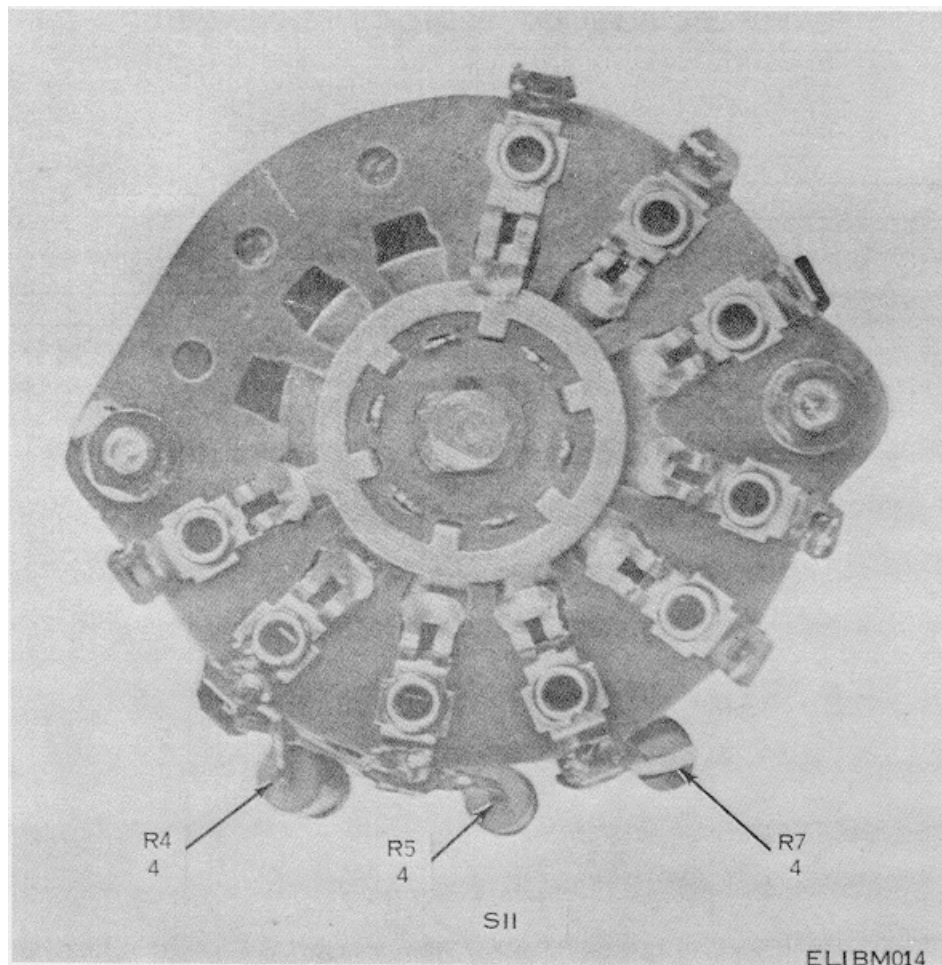

Figure 10. Switch assemblies (Sheet 3 of 4).

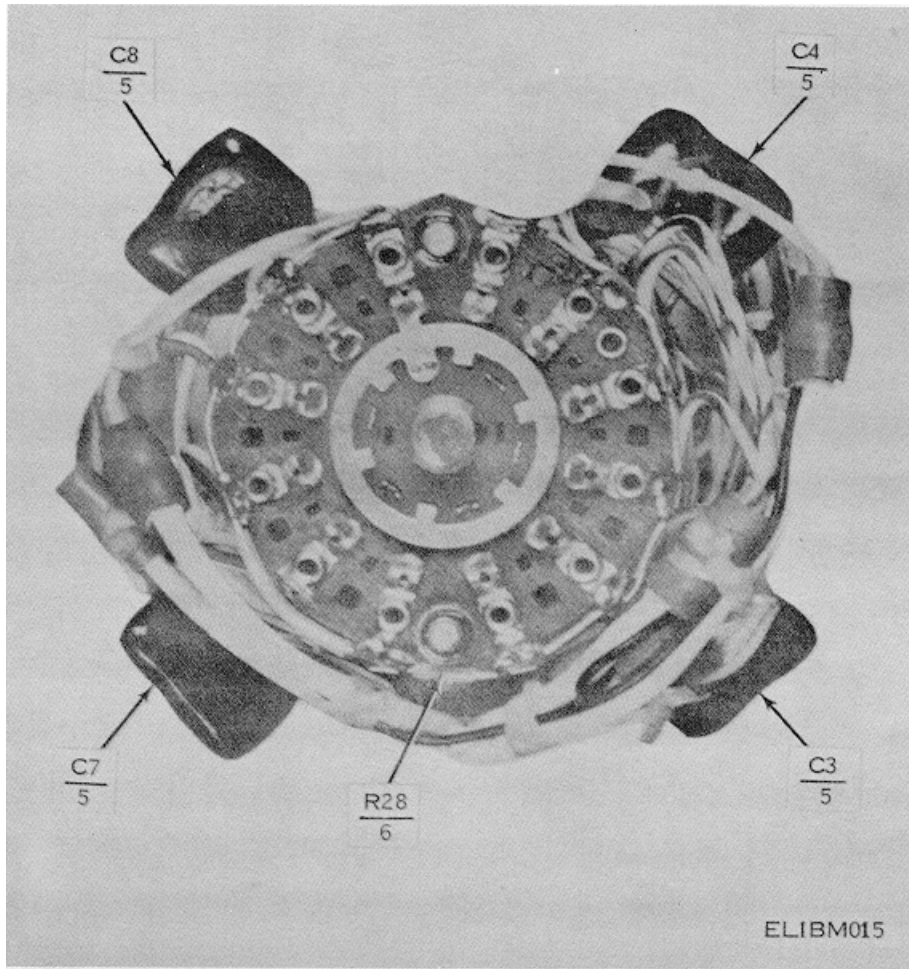

Figure 10. Switch assemblies (Sheet 4 of 4)

SECTION V. REPAIR PARTS LIST (AN/APM-247) (CONTINUED)

(1) ILLUSTRATION		(2)	(3)	(4)	(5)	(6) DESCRIPTION	(7)	(8)
(a) FIG NO.	(b) ITEM NO.	SMR CODE	NATIONAL STOCK NUMBER	PART NUMBER	FSCM	USABLE ON CODE	U/M	QTY INC IN UNIT
10	1	PAHZZ	5905-00-761-1900	RX60D1912F	81349	RESISTOR, FIXED, FILM	EA	2
10	2	PAIZZ	5905-00-721-2380	RNC60K1961FS	81349	RESISTOR, FIXED, FILM	EA	2
10	3	PAHZZ	5905-00-988-2310	RX60D1000F	81349	RESISTOR, FIXED, FILM	EA	1
10	4	XDHZZ		DCS1-249903F	91637	RESISTOR, FIXED, FIILM	EA	3
10	5	PAHZZ	5910-00-880-6080	CM06FD122003	81349	CAPACITOR, FIXCD, MICA DIELECTRIC	EA	4
10	6	XDHZZ		DCS1-219103F	91637	RESISTOR, FIXED, FILM	EA	1

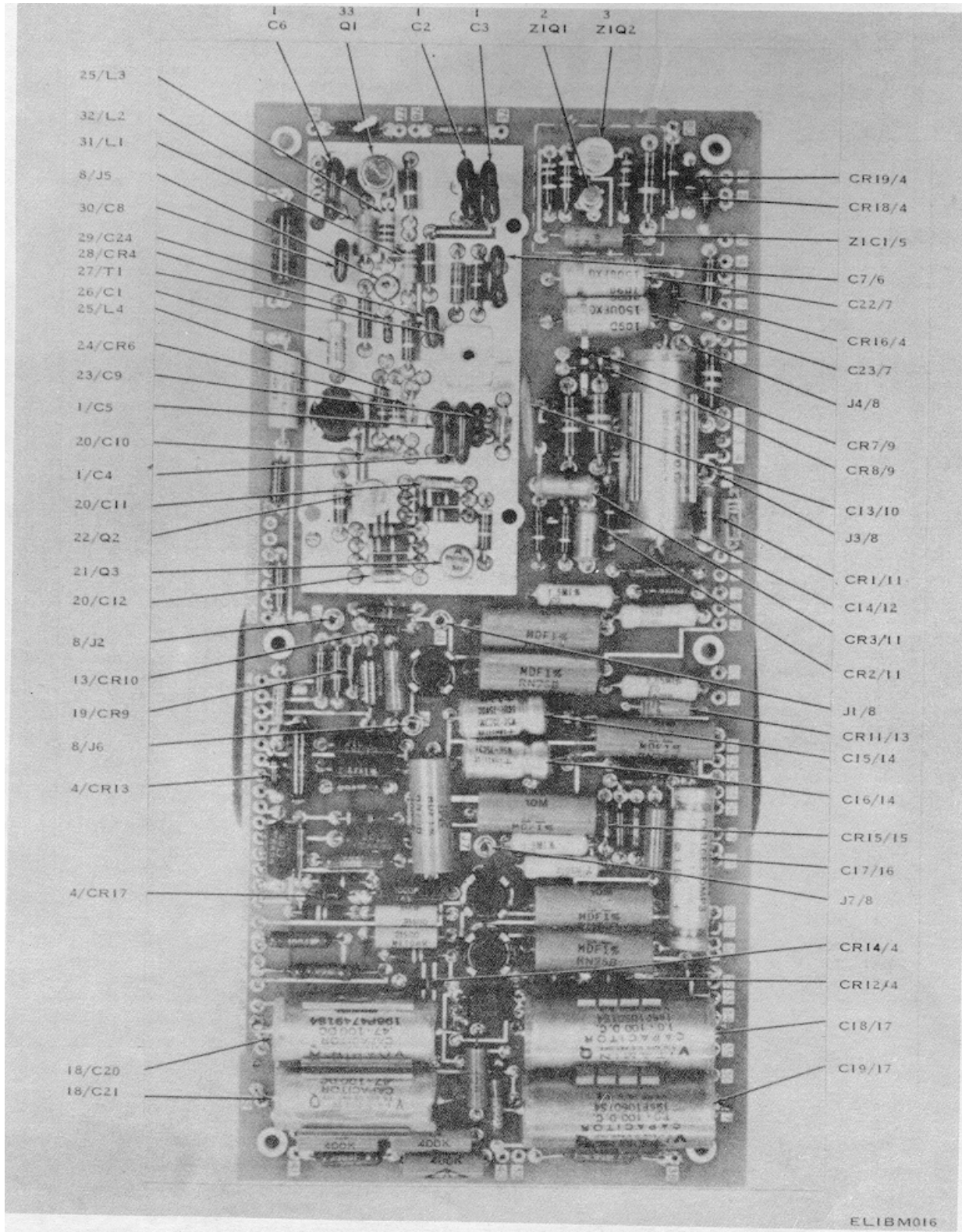

Figure 11. Printed circuit board (Sheet I of 2).

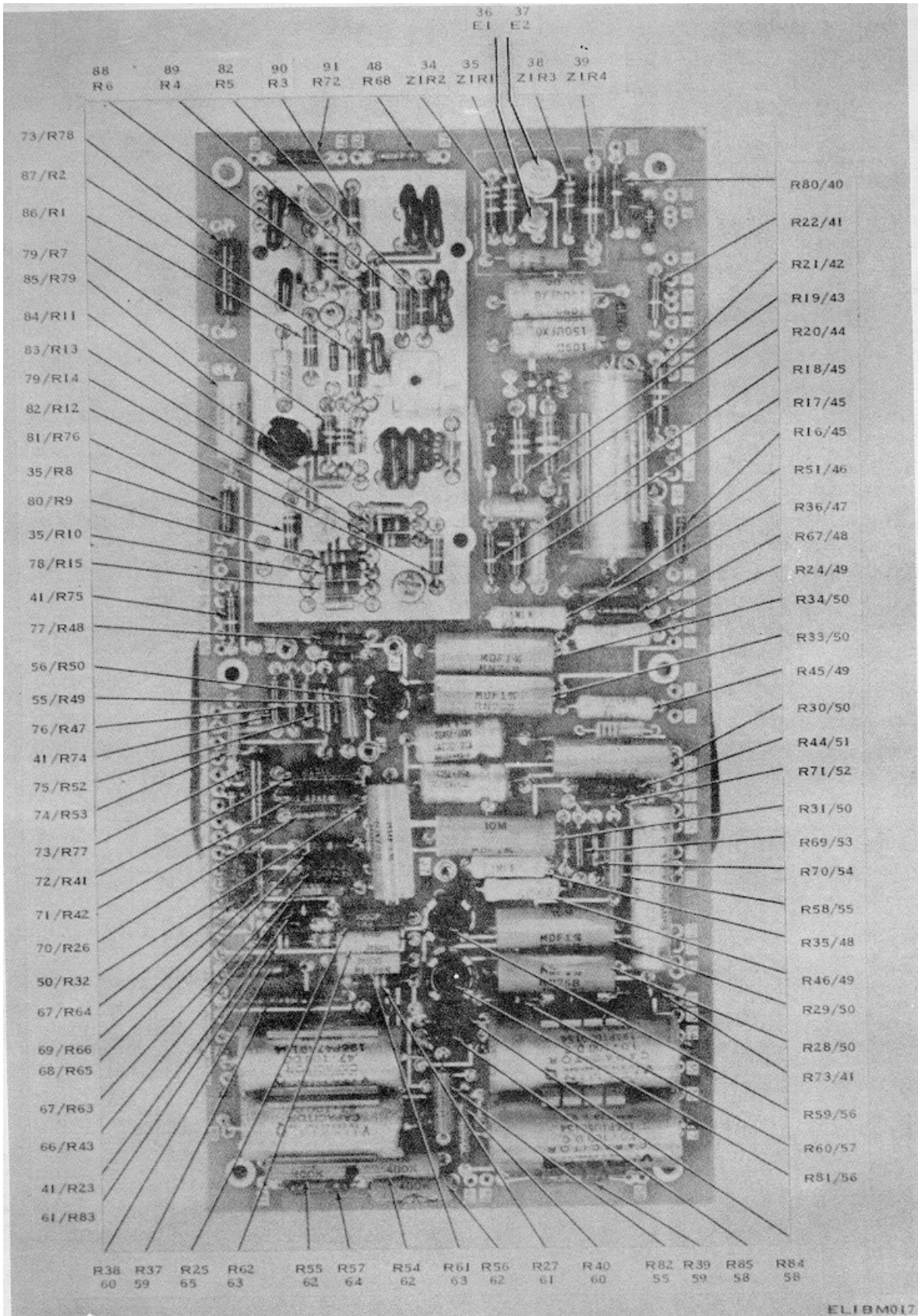

Figure 11. Printed circuit board (Sheet 2 of 2)

SECTION V. REPAIR PARTS LIST (AN/APM-247) (CONTINUED)

(1) ILLUSTRATION		(2)	(3)	(4)	(5)	(6) DESCRIPTION	(7)	(8)
(a) FIG NO.	(b) ITEM NO.	SMR CODE	NATIONAL STOCK NUMBER	PART NUMBER	FSCM	USABLE ON CODE	U/M	QTY INC IN UNIT
11	1	PAHZZ	5910-00-717-0167	CM06FD471G03	81349	CAPACITOR, FIXD, MICA DIELECTRIC	EA	5
11	2	PAHZZ	5961-00-787-5305	JAN2N18A	81349	TRANSISTOR	EA	1
11	3	PAHZZ	5961-00-855-1551	JAN2N1132	81349	TRANSISTOR	EA	1
11	4	PAHZZ	5961-00-087-6047	JAN1N645	81319	SEMICONDUCTOR DEVICE, DIODE	EA	7
11	5	PAHZZ	5910-00-010-8192	M39003-01-3097	81349	CAPACITOR, FIXED, ELECTROLYTIC	EA	1
11	6	PAHZZ	5910-00-965-9441	CM06FD102G03	81349	CAPACITOR, FIXED, MICA DIELECTRIC	EA	1
11	7	PAHZZ	5910-00-010-4913	M39006-09-6515	81349	CAPACITOR, FIXED, ELECTROLYTIC	EA	2
11	8	PAHZZ	5935-00-767-8187	31-1	81073	JACK, TIP	EA	7
11	9	PAHZZ	5961-00-851-5926	1N986B	81349	SEMICONDUCTOR DEVICE, DIODE	EA	2
11	10	PAHZZ	5910-00-929-0913	41C191	56289	CAPACITOR, FIXED, CERAMIC DIELECTRIC	EA	1
11	11	PAHZZ	5961-00-972-9395	1N3256	80131	SEMICONDUCTOR DEVICE, DIODE	EA	3
11	12	XDHZZ		SDB1K06154M	53021	CAPACITOR, FIXED, PAPER DIELECTRIC	EA	1
11	13	PAHZZ	5961-00-821-2309	JAN1N751A	81349	SEMICONDUCTOR DEVICE, DIODE	EA	2
11	14	PAHZZ	5910-00-005-3181	109D566X0075T2	56289	CAPACITOR, FIXED, ELECTROLYTIC	EA	2
11	15	PAHZZ	5961-00-556-2091	JAN1N270	81349	SEMICONDUCTOR DEVICE, DIODE	EA	1
11	16	PAHZZ	5910-00-110-9195	CL31BG350MPE	81349	CAPACITOR, FIXED, ELECTROLYTIC	EA	1
11	17	PAHZZ	5910-00-818-9760	SDB1K01105M	53021	CAPACITOR, FIXED, PAPER DIELECTRIC	EA	2
11	18	PAHZZ	5910-00-008-9623	196P4749154	56289	CAPACITOR, FIXED, PAPER DIELECTRIC	EA	2
11	19	PAHZZ	5961-00-877-8618	JAN1N976B	81349	SEMICONDUCTOR DEVICE, DIODE	EA	1
11	20	PAHZZ	5910-00-113-5685	M39003-01-3043	81349	CAPACITOR, FIXED, ELECTROLYTIC	EA	3
11	21	PAHZZ	5961-00-837-1757	2N388A	80131	TRANSISTOR	EA	1
11	22	PAHZZ	5961-00-985-9134	JAN2N404A	81349	TRANSISTOR	EA	1
11	23	PAHZZ	5910-00-957-2054	CM05ED330G03	81349	CAPACITOR, FIXED, MICA DIELECTRIC	EA	1
11	24	PAHZZ	5961-00-842-9864	JAN1N914	81349	SEMICONDUCTOR DEVICE, DIODE	EA	1
11	25	PAHZZ	5950-00-707-1243	MS18130-20	96906	COIL, RADIO FREQUENCY	EA	2
11	26	PAHZZ	5910-00-165-2797	M39006-09-6523	81349	CAPACITOR, FIXED, ELECTROLYTIC	EA	1
11	27	PAHZZ	5950-00-777-4974	X165-1	81815	TRANSFORMER, RADIO FREQUENCY	EA	1
11	28	PAHZZ	5961-00-060-3926	1N758	01295	SEMICONDUCTOR DEVICE, DIODE	EA	1
11	29	PAHZZ	5910-00-984-7588	CM05FD101G03	81349	CAPACITOR, FIXED, MICA DIELECTRIC	EA	1
11	30	PAHZZ	5910-00-954-5504	CM05FD121G03	81349	CAPACITOR, FIXED, MICA DIELECTRIC	EA	1
11	31	PAHZZ	5950-00-043-0423	MS18130-24	96906	COIL, RADIO FREQUENCY	EA	1
11	32	PAHZZ	5950-00-769-4326	MS18130-1	96906	COIL, RADIO FREQUENCY	EA	1
11	33	PAHZZ	5961-00-844-6717	2N502A	81349	TRANSISTOR	EA	1
11	34	PAHZZ	5905-00-104-8348	RCR20G332JS	81349	RESISTOR, FIXED, COMPOSITION	EA	3
11	35	PAHZZ	5905-00-141-0596	RCR20G473JS	81349	RESISTOR, FIXED, COMPOSITION	EA	1
11	36	PAHZZ	5961-00-830-4796	7717-63	13103	INSULATOR, TRANSISTOR	EA	1
11	37	PAHZZ	5961-00-713-0913	7717-22DAP	13103	INSULATOR, DISK	EA	1
11	38	PAHZZ	5905-00-104-8334	RCR20G331JS	81349	RESISTOR, FIXED, COMPOSITION	EA	1
11	39	PAHZZ	5905-00-104-8343	RCR32G100JS	81349	RESISTOR, FIXED, COMPOSITION	EA	1
11	40	PAHZZ	5905-00-110-196	RCR20G102JS	81349	RESISTOR, FIXED, COMPOSITION	EA	1
11	41	PAHZZ	5905-00-104-5755	RCR20G100JS	81349	RESISTOR, FIXED, COMPOSITION	EA	5
11	42	PAHZZ	5905-00-106-1276	RCR32G104JS	81349	RESISTOR, FIXED, COMPOSITION	EA	1

SECTION V. REPAIR PARTS LIST (AN/APM-247) (CONTINUED)

(1) ILLUSTRATION		(2)	(3)	(4)	(5)	(6) DESCRIPTION	(7)	(8)
(a) FIG NO.	(b) ITEM NO.	SMR CODE	NATIONAL STOCK NUMBER	PART NUMBER	FSCM	USABLE ON CODE	U/M	QTY INC IN UNIT
11	43	PAHZZ	5905-00-247-8735	RCR32G563JS	81349	RESISTOR, FIXED, COMPOSITION	EA	1
11	44	PAHZZ	5905-00-247-8749	RCR32G823JS	81349	RESISTOR, FIXED, COMPOSITION	EA	1
11	45	PAHZZ	5905-00-104-5756	RCR20G105JS	81349	RESISTOR, FIXED, COMPOSITION	EA	3
11	46	PAHZZ	5905-00-131-5807	RNC65K1003FS	81349	RESISTOR, FIXED, FILM	EA	1
11	47	PAHZZ	5905-00-101-1695	RNC70K1504FS	81349	RESISTOR, FIXED, FILM	EA	1
11	48	PAHZZ	5905-00-761-1900	RN60D1912F	81349	RESISTOR, FIXED, FILM	EA	2
11	49	PAHZZ	5905-00-053-1167	RN70D2054F	81349	RESISTOR, FIXED, FILM	EA	3
11	50	XDHZZ		MF1X000N1000F	91637	RESISTOR, FIXED, FILM	EA	7
11	51	PAHZZ	5905-00-834-6263	705-5024-000	13499	RESISTOR, FIXED, FILM	EA	1
11	52	PAHZZ	5905-00-988-2307	RN60D1003F	81349	RESISTOR, FIXED, FILM	EA	1
11	53	PAHZZ	5905-00-763-6531	RN60D1021F	81349	RESISTOR, FIXED, FILM	EA	1
11	54	PAHZZ	5905-00-432-6410	RNC60K1001FS	81349	RESISTOR, FIXED, FILM	EA	1
11	55	PAHZZ	5905-00-993-6974	RN65D1780F	81349	RESISTOR, FIXED, FILM	EA	3
11	56	PAHZZ	5905-00-937-7356	FP101M	01121	RESISTOR, VARIABLE	EA	3
11	57	PAHZZ	5905-00-126-6691	RCR20G150JS	81349	RESISTOR, FIXED, COMPOSITION	EA	1
11	58	PAHZZ	5905-00-189-2460	RNC60K1913FS	81349	RESISTOR, FIXED, FILM	EA	2
11	59	XDHZZ		DCS1-249903F	91637	RESISTOR, FIXED, FILM	EA	2
11	60	PAHZZ	5905-00-892-6475	RN65D1004F	81349	RESISTOR, FIXED, FILM	EA	2
11	61	PAHZZ	5905-00-114-5393	RCR20G224JS	81349	RESISTOR, FIXED, COMPOSITION	EA	2
11	62	XDHZZ		DCC705-2248-000	75042	RESISTOR, FIXED, FILM	EA	3
11	63	PAHZZ	5905-00-063-8405	RN65D2151F	81349	RESISTOR, FIXED, FILM	EA	2
11	64	PAHZZ	5905-00-080-2904	RN65D1963F	81349	RESISTOR, FIXED, FILM	EA	1
11	65	PAHZZ	5905-00-421-2942	RNC65H1000FS	81349	RESISTOR, FIXED, FILM	EA	1
11	66	PAHZZ	5905-00-801-1208	RN70C1473F	81349	RESISTOR, FIXED, FILM	EA	1
11	67	PAHZZ	5905-00-884-1598	RSM2C20R00F	91637	RESISTOR, FIXED, WIREWOUND	EA	2
11	68	PAHZZ	5905-00-141-0595	RCR20G472JS	81349	RESISTOR, FIXED, COMPOSITION	EA	1
11	69	PAHZZ	5905-00-111-4738	RCR20G152J5	81349	RESISTOR, FIXED, COMPOSITION	EA	1
11	70	PAHZZ	5905-00-763-5328	RN60D2941F	81349	RESISTOR, FIXED, FILM	EA	1
11	71	PAHZZ	5905-00-822-2449	RN70C2871F	81349	RESISTOR, FIXED, FILM	EA	1
11	72	PAHZZ	5905-00-443-8995	RNC70K2150FS	81349	RESISTOR, FIXED, FILM	EA	1
11	73	PAHZZ	5905-00-430-1949	RNC70K42R2FS	81349	RESISTOR, FIXED, FILM	EA	2
11	74	PAHZZ	5905-00-432-0468	RNC60K3923FS	81349	RESISTOR, FIXED, FILM	EA	1
11	75	XDHZZ		A205S495KPORM-1	05347	RESISTOR, FIXED, WIREWOUND	EA	1
11	76	PAHZZ	5905-00-114-5352	RCR20G111J5	81349	RESISTOR, FIXED, COMPOSITION	EA	1
11	77	PAHZZ	5905-00-104-8350	RCR20G221JS	81349	RESISTOR, FIXED, COMPOSITION	EA	1
11	78	PAHZZ	5905-00-494-5517	RCR20G472KM	81349	RESISTOR, FIXED, COMPOSITION	EA	1
11	79	PAHZZ	5905-00-104-8336	RCR20G104JS	81349	RESISTOR, FIXED, COMPOSITION	EA	2
11	80	PAHZZ	5905-00-104-8330	RCR20G333J5	81349	RESISTOR, FIXED, COMPOSITION	EA	1
11	81	PAHZZ	5905-00-025-5988	RNC60K3321FS	81349	RESISTOR, FIXED, FILM	EA	1
11	82	PAHZZ	5905-00-111-4858	RCR20G471JS	81349	RESISTOR, FIXED, COMPOSITION	EA	2
11	83	PAHZZ	5905-00-110-0310	RCR20G392JS	81349	RESISTOR, FIXED, COMPOSITION	EA	1
11	84	PAHZZ	5905-00-824-3057	FP102U	01121	RESISTOR, VARIABLE	EA	1

SECTION V. REPAIR PARTS LIST (AN/APM-247) (CONTINUED)

(1) ILLUSTRATION		(2)	(3)	(4)	(5)	(6)	(7)	(8)
(a) FIG NO.	(b) ITEM NO.	SMR CODE	NATIONAL STOCK NUMBER	PART NUMBER	FSCM	DESCRIPTION USABLE ON CODE	U/M	QTY INC IN UNIT
11	85	PAHZZ	5905-00-721-2380	RNC60K1961FS	81349	RESISTOR, FIXED, FILM	EA	1
11	86	PAHZZ	5905-00-141-0598	RCR20G561JS	81349	RESISTOR, FIXED, COMPOSITION	EA	1
11	87	PAHZZ	5905-00-106-9344	RCR20G101JS	81349	RESISTOR, FIXED, COMPOSITION	EA	1
11	88	PAHZZ	5905-00-141-1168	RCR20G222JS	81349	RESISTOR, FIXED, COMPOSITION	EA	1
11	89	PAHZZ	5905-00-141-1165	RCR20G682JS	81349	RESISTOR, FIXED, COMPOSITION	EA	1
11	90	PAHZZ	5905-00-141-0600	RCR20C822JS	81349	RESISTOR, FIXED, COMPOSITION	EA	1
11	91	PAHZZ	5905-00-847-5063	RN60C5490F	81349	RESISTOR, FIXED, FILM	EA	1



CABLE W1

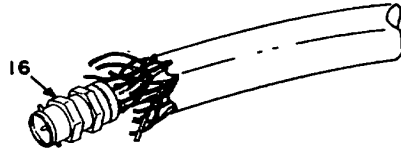
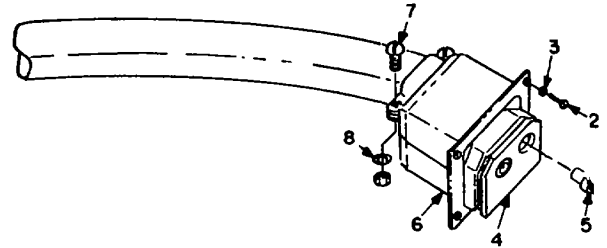

CABLE W2

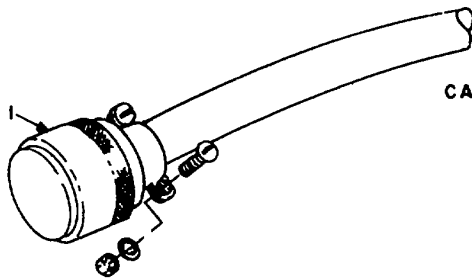
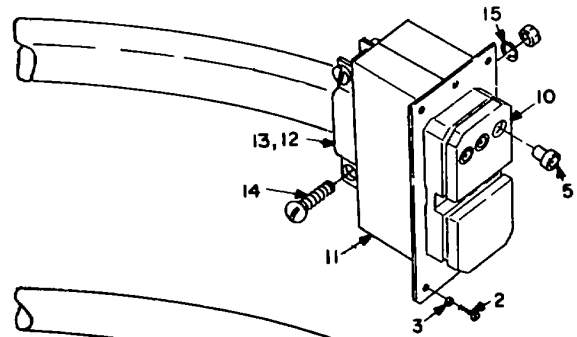

CABLE W3, W4



ELIBMOI

Figure 12. Cables for TS-2081()/APM-247

SECTION V. REPAIR PARTS LIST (AN/APM-247) (CONTINUED)

(1) ILLUSTRATION		(2)	(3)	(4)	(5)	(6) DESCRIPTION	(7)	(8)
(a) FIG NO.	(b) ITEM NO.	SMR CODE	NATIONAL STOCK NUMBER	PART NUMBER	FSCM	USABLE ON CODE	U/M	QTY INC IN UNIT
12	1	PAHZZ	5935-00-717-2591	MS3116F18-32S	96906	CONNECTOR, PLUG, ELECTRICAL	EA	2
12	2	PAHZZ	5305-00-054-5649	MS51957-15	96906	SCREW, MACHINE	EA	8
12	3	PAHZZ	5310-00-933-8118	MS35338 135	96906	WASHER, LOCK	EA	8
12	4	PAHZZ	5935-00-773-3744	DPX32C2-338	71468	CONNECTOR ASSEMBLY, ELECTRICAL	EA	1
12	5	PAHZZ	5935-00-937-2265	RF-6621-78	94375	CONNECTOR, JACK, CABLE	EA	5
12	6	PAHZZ	5935-00-878-1639	425170-01	07690	ADAPTER, CABLE TO CONNECTOR	EA	1
12	7	PAHZZ	5305-00-402-5788	MS51957-127	96906	SCREW, MACHINE	EA	2
12	8	PAHZZ	5310-00-933-8119	MS35338-137	96906	WASHER, LOCK	EA	2
12	9	PAHZZ	5935-00-850-9157	UG260FU	80058	CONNECTOR, PLUG, ELECTRICAL	EA	2
12	10	PAHZZ	5935-00-930-5929	MSS5935-01	08288	CONNECTOR ASSEMBLY, ELECTRICAL	EA	1
12	11	PAHZZ	5935-00-839-6714	S138	07418	ADAPTER, CABLE TO CONNECTOR	EA	1
12	12	PAHZZ	5365-00-141-6943	MS3420-16	96906	BUSHING, CABLE	EA	2
12	13	PAHZZ	5365-00-754-1562	MS3420-20	96906	BUSHING, CABLE	EA	1
12	14	PAHZZ	5305-00-071-2087	MS51957-84	96906	SCREW, MACHINE	EA	2
12	15	PAHZZ	5310-00-9338121	MS35338-139	96906	WASHER, LOCK	EA	2
12	16	PAHZZ	5935-00-836-6522	UG910CU	80058	CONNECTOR, JACK, ELECTRICAL	EA	3

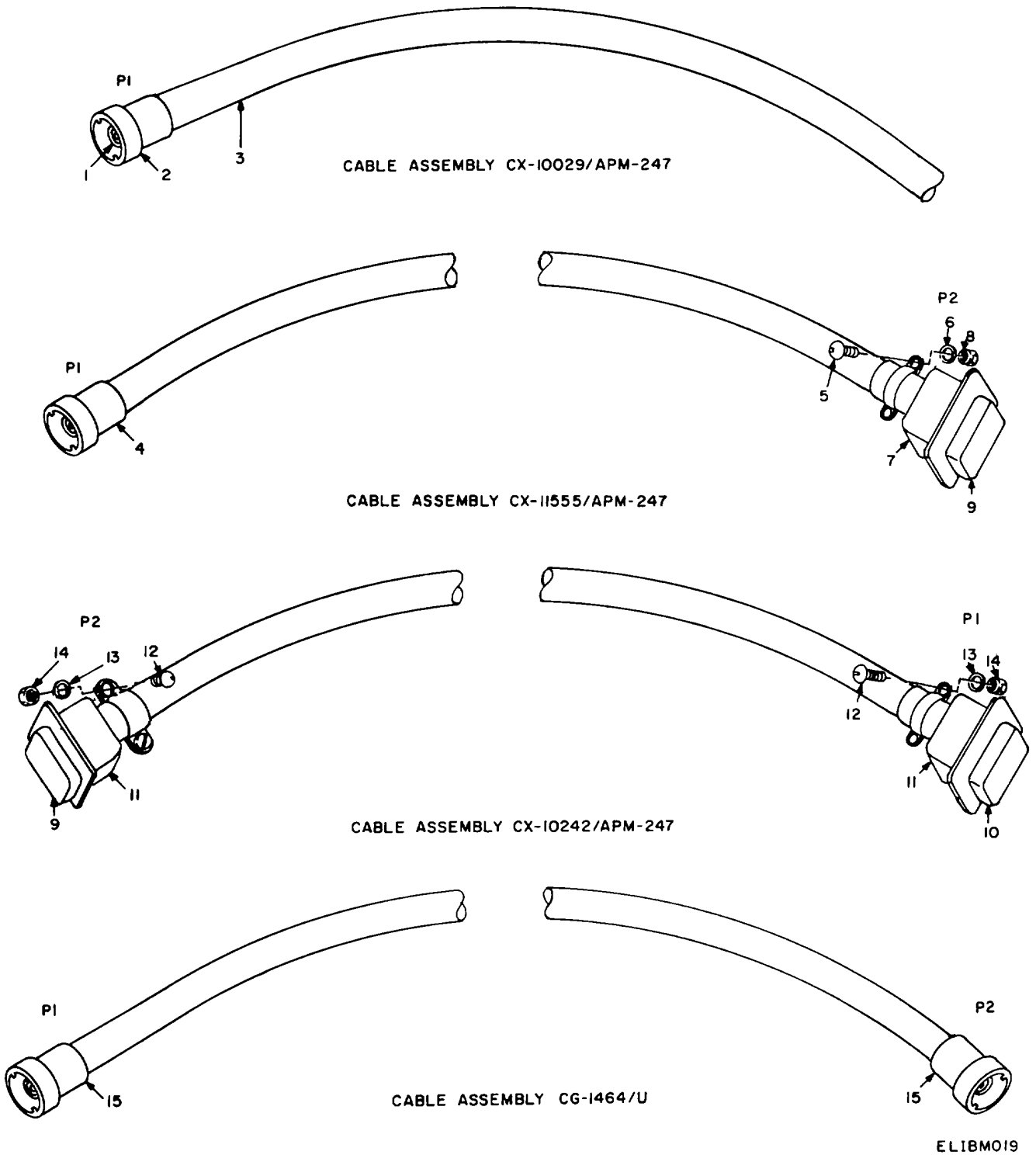

Figure 13. Cable Assemblies for AN/APM-247.

SECTION V. REPAIR PARTS LIST (AN/APM-247) (CONTINUED)

(1) ILLUSTRATION		(2)	(3)	(4)	(5)	(6) DESCRIPTION	(7)	(8)
(a) FIG NO.	(b) ITEM NO.	SMR CODE	NATIONAL STOCK NUMBER	PART NUMBER	FSCM	USABLE ON CODE	U/M	QTY INC IN UNIT
13	1	PAHZZ	5935-00-539-2650	MS3106A10SL3SC	96906	GROUP: 02 CABLE ASSEMBLIES FOR AN/APM-247		
13	2	PAHZZ	5935 00-24D-0173	MS3057-4A	96906	GROUP: 0201 CABLE ASSEMBLY, POWER, ELECTRICAL CX-10029/APM-247		
13	3	XDHZZ		30TYPESJ3-18	24342	CONNECTOR, RECEPTACLE, ELECTRICAL ADAPTER, CABLE CABLE, POWER	EA EA FT	1 1 V
13	4	PAHZZ	5935-00-779-8295	MS3116F14-19S	96906	GROUP: 0202 CABLE ASSEMBLY, SPECIAL PURPOSE, ELECTRICAL CX-11555/APM-247		
13	5	PAHZZ	5305-00-054-5647	MS51957-13	96906	CONNECTOR, PLUG, ELECTRICAL	EA	1
13	6	PAHZZ	5310-00-933-8118	MS35338-135	96906	SCREW, MACHINE	EA	2
13	7	XDHZZ		JSDA19678-1	71468	WASHER, LOCK	EA	2
13	8	PAHZZ	5100-00-208-3786	NAS671C4	80205	CONNECTOR, SHELL	EA	1
13	9	PAHZZ	5935-00-064-1870	DA15PC33	71468	NUT, PLAIN, HEX	EA	2
13	10	PAHZZ	5935-00-327-9301	DA15SC37	71468	GROUP: 0203 CABLE ASSEMBLY, SPECIAL PURPOSE, ELECTRICAL CX-1024 2/APM-24 7		
13	11	XDHZZ		JSDA19678-1	71468	CONNECTOR, RECEPTACLE, ELECTRICAL	EA	1
13	12	PAHZZ	5305-00-054-5647	MS51957-13	96906	CONNECTOR, SHELL	EA	2
13	13	PAHZZ	5310-00-933-8118	MS35338-135	96906	SCREW, MACHINE	EA	4
13	14	PAHZZ	5310-00-208-3786	NAs671C4	80205	WASHER, LOCK	EA	4
13	15	PAHZZ	5935-00-850-9157	UC260FU	80058	NUT, PLAIN, HEX	EA	4
						GROUP: 0204 CABLE ASSEMBLY, RADIO FREQUENCY, CC-1464/U		
						CONNECTOR, PLUG, ELECTRICAL	EA	12

SECTION V. REPAIR PARTS LIST (AN/APM-247) (CONTINUED)

(1) ILLUSTRATION		(2)	(3)	(4)	(5)	(6) DESCRIPTION	(7)	(8)
(a) FIG NO.	(b) ITEM NO.	SMR CODE	NATIONAL STOCK NUMBER	PART NUMBER	FSCM	USABLE ON CODE	U/M	QTY INC IN UNIT
						GROUP: 03 BULK MATERIAL		
BULK		PAHZZ	6145-00-056-8814	WH65333-01-02-01	50625	WIRE, ELECTRICAL		FT
BULK		PAHZZ	6145-00-060-9083	WTE730A903	90484	WIRE, ELECTRICAL		FT
BULK		PAHZZ	6145-00-060-9097	WTE734ACW913	90484	WIRE, ELECTRICAL		FT
BULK		PAHZZ	6145-00-060-9500	WTE734ACW93	90484a	WIRE, ELECTRICAL		FT
BULK		PAHZZ	6145-00-060-9503	WTE734ACW9	90484	WIRE, ELECTRICAL		FT
BULK		PAHZZ	6145-00-060-9504	WTE734ACW91	90484	WIRE, ELECTRICAL		FT
BULK		PAHZZ	6145-00-060-9505	WTE734ACW92	90484	WIRE, ELECTRICAL		FT
BULK		PAHZZ	6145-00-060-9507	WTE734ACW90	90484	WIRE, ELECTRICAL		FT
BULK		PAHZZ	6145-00-060-9511	WTE734ACW96	90484	WIRE, ELECTRICAL		FT
BULK		PAHZZ	6145-00-060-9512	WTE734ACW95	90484	WIRE, ELECTRICAL		FT
BULK		PAHZZ	6145-00-080-3022	WTE734ACW4	90484	WIRE, ELECTRICAL		FT
BULK		PAHZZ	6145-00-103-0712	WTE734ACW925	90484	WIRE, ELECTRICAL		FT
BULK		PAHZZ	6145-00-103-0713	WTE734ACW923	90484	WIRE, ELECTRICAL		FT
BULK		PAHZZ	6145-00-103-0714	WTE734ACW916	90484	WIRE, ELECTRICAL		FT
BULK		PAHZZ	6145-00-103-0716	WTE734ACW915	90484	WIRE, ELECTRICAL		FT
BULK		PAHZZ	6145-00-103-0718	WTE734ACW936	90484	WIRE, ELECTRICAL		FT
BULK		PAHZZ	6145-00-103-0719	WTE734ACW935	90484	WIRE, ELECTRICAL		FT
BULK		PAHZZ	6145-00-103-0720	WTE734ACW926	90484	WIRE, ELECTRICAL		FT
BULK		PAHZZ	6145-00-103-3053	WTE734ACW956	90484	WIRE, ELECTRICAL		FT
BULK		PAHZZ	6145-00-113-3909	WTE734ACW903	90484	WIRE, ELECTRICAL		FT
BULK		PAHZZ	6145-00-113-3910	WTE734ACW906	90484	WIRE, ELECTRICAL		FT
BULK		PAHZZ	6145-00-113-3911	WTE734ACW905	90484	WIRE, ELECTRICAL		FT
BULK		PAHZZ	6145-00-113-6278	WTE734ACW912	90484	WIRE, ELECTRICAL		FT
BULK		PAHZZ	6145-00-147-6413	WTE734CW7	90484	WIRE, ELECTRICAL		FT
BULK		PAHZZ	6145-00-160-4775	421-2220-000	13499	WIRE, ELECTRICAL		FT
BULK		PAHZZ	6145-00-199-8068	WH65333-08-04-01	50625	WIRE, ELECTRICAL		FT
BULK		PAHZZ	6145-00-295-2810	F20WHITE	81349	WIRE, ELECTRICAL		FT
BULK		PAHZZ	6145-00-500-3079	MM2946	99974	WIRE, ELECTRICAL		FT
BULK		PAHZZ	6145-00-548-0969	WTE730A9	90484	WIRE, ELECTRICAL		FT
BULK		PAHZZ	6145-00-578-6824	WTE730A6	90484	WIRE, ELECTRICAL		FT
BULK		PAHZZ	6145-00-578-6975	WTE730A7	90484	WIRE, ELECTRICAL		FT
BULK		PAHZZ	6145-00-578-6978	WTE730A8	90484	WIRE, ELECTRICAL		FT
BULK		PAHZZ	6145-00-581-1621	439-4296-00	13499	WIRE, ELECTRICAL		FT
BULK		PAHZZ	6145-00-581-1622	439-4292-00	13499	WIRE, ELECTRICAL		FT
BULK		PAHZZ	6145-00-581-1623	E20GREEN	81349	WIRE, ELECTRICAL		FT
BULK		PAHZZ	6145-00-581-1624	XE2072861-3	28581	WIRE, ELECTRICAL		FT
BULK		PAHZZ	6145-00-581-1625	WTE728A2	90484	WIRE, ELECTRICAL		FT
BULK		PAHZZ	6145-00-581-1626	439-4297-000	13499	WIRE, ELECTRICAL		FT
BULK		PAHZZ	6145-00-581-9324	WTE730A1	90484	WIRE, ELECTRICAL		FT
BULK		PAHZZ	6145-00-610-1937	RG59BU	80058	WIRE, ELECTRICAL		FT
BULK		PAHZZ	6145-00-623-7224	WTE730A2	90484	WIRE, ELECTRICAL		FT
BULK		PAHZZ	6145-00-623-7225	WTE730A5	90484	WIRE, ELECTRICAL		FT

SECTION V. REPAIR PARTS LIST (AN/APM-247) (CONTINUED)

(1) ILLUSTRATION		(2)	(3)	(4)	(5)	(6) DESCRIPTION	(7)	(8)
(a) FIG NO.	(b) ITEM NO.	SMR CODE	NATIONAL STOCK NUMBER	PART NUMBER	FSCM	USABLE ON CODE	U/M	QTY INC IN UNIT
BULK		PAHZZ	6145-00-669-6642	421-1820-000	13499	WIRE, ELECTRICAL	FT	
BULK		PAHZZ	6145-00-686-4465	WTE734ACW902	90484	WIRE, ELECTRICAL	FT	
BULK		PAHZZ	6145-00-686-4939	WTE730A93	90484	WIRE, ELECTRICAL	FT	
BULK		PAHZZ	6145-00-686-4940	WTE730A92	90484	WIRE, ELECTRICAL	FT	
BULK		PAHZZ	6145-00-686-4941	WTE730A91	90484	WIRE, ELECTRICAL	FT	
BULK		PAHZZ	6145-00-721-8921	WH65333-09-06-01	50625	WIRE, ELECTRICAL	FT	
BULK		PAHZZ	6145-00-822-3473	WTE734ACW1	90484	WIRE, ELECTRICAL	FT	
BULK		PAHZZ	6145-00-822-3474	WTE734ACW2	90484	WIRE, ELECTRICAL	FT	
BULK		PAHZZ	6145-00-822-3475	WTE734ACW3	90684	WIRE, ELECTRICAL	FT	
BULK		PAHZZ	6145-00-822-3481	WTE22A9	90484	WIRE, ELECTRICAL	FT	
BULK		PAHZZ	6145-00-822-4033	WTE734ACW0	90484	WIRE, ELECTRICAL	FT	
BULK		PAHZZ	6145-00-838-6994	WTE734ACW6	90484	WIRE, ELECTRICAL	FT	
BULK		PAHZZ	6145-00-838-6995	WTE734ACW8	90484	WIRE, ELECTRICAL	FT	
BULK		PAHZZ	6145-00-838-9446	WTE734ACW5	90484	WIRE, ELECTRICAL	FT	
BULK		PAHZZ	6145-00-880-6380	WH65333-01-14-01-02-01	50625	WIRE, ELECTRICAL	FT	
BULK		PAHZZ	6145-00-880-6381	WH65333-01-14-01-09-01	50625	WIRE, ELECTRICAL	FT	
BULK		PAHZZ	6145-00-880-6382	WH65333-01-14-01-08-01	50625	WIRE, ELECTRICAL	FT	
BULK		PAHZZ	6145-00-880-6388	WH65333-01-14-01-04-01	50625	WIRE, ELECTRICAL	FT	
BULK		PAHZZ	6145-00-993-8809	WH66817-95	50625	WIRE, ELECTRICAL	FT	
BULK		PAHZZ	6145-00-993-8811	WH66817-96	50625	WIRE, ELECTRICAL	FT	
BULK		PAHZZ	6145-01-009-6429	WH65333-01-14-01-06-01	50625	WIRE, ELECTRICAL	FT	
BULK		PAHZZ	6145-01-012-3975	WH66817-93	50625	WIRE, ELECTRICAL	FT	
BULK		PAHZZ		RTE730A915	99114	WIRE, ELECTRICAL	FT	
BULK		PAHZZ		TX18-1930-0	99114	WIRE, ELECTRICAL	FT	
BULK		PAHZZ		TX18-1930-5	99114	WIRE, ELECTRICAL	FT	
BULK		PAHZZ		TX18-1930-6	99114	WIRE, ELECTRICAL	FT	
BULK		PAHZZ		WH65333-01-09-01-06-01	50625	WIRE, ELECTRICAL	FT	
BULK		PAHZZ		WTE18A	90484	WIRE, ELECTRICAL	FT	
BULK		PAHZZ		XE2072881-0	28581	WIRE, ELECTRICAL	FT	
BULK		PAHZZ		XE2072881-7	28581	WIRE, ELECTRICAL	FT	
BULK		PAHZZ		XE2072881-8	28581	WIRE, ELECTRICAL	FT	
BULK		PAHZZ		XE2072881-90	28581	WIRE, ELECTRICAL	FT	
BULK		PAHZZ		1XT22730-4	12515	WIRE, ELECTRICAL	FT	
BULK		PAHZZ		1XT22730-95	12515	WIRE, ELECTRICAL	FT	
BULK		PAHZZ		421-2020-000	99114	WIRE, ELECTRICAL	FT	

SECTION VII. NATIONAL STOCK NUMBER AND PART NUMBER INDEX (AN/APM-247)

STOCK NUMBER	FIG. NO.	ITEM NO.	STOCK NUMBER	FIG. NO.	ITEM NO.
3010-00-937-6448	9	7	5310-00-933-8119	12	8
5305-00-050-9226	9	9	5310-00-933-8120	8	14
5305-00-054-5639	8	30	5310-00-933-8121	12	15
5305-00-054-5644	6	6	5310-00-934-9759	8	8
5305-00-054-5647	8	68	5310-00-938-2013	8	27
5305-00-054-5647	13	5	5310-010014-5499	7	13
5305-00-054-5647	13	12	5320-00-117-6949	6	15
5305-00-054-5649	8	25	5340-00-275-6633	8	7
5305-00-054-5649	12	2	5340-00-559-8846	8	21
5305-00-054-5651	7	36	5340-00-619-7754	8	56
5305-00-054-6651	8	1	5340-00-664-6732	8	43
5305-00-054-6652	8	42	5340-00-782-8737	8	41
5305-00-054-6668	8	12	5340-00-787-8674	8	37
5305-00-054-6669	8	44	5340-00-855-3230	8	70
5305-00-059-3658	8	13	5340-00-945-1027	8	58
5305-00-071-2087	12	14	5340-00-964-2555	8	26
5305-00-402-5788	12	7	5340-00-964-2557	8	53
5305-00-719-5342	7	38	5340-00-969-6501	8	62
5305-00-763-6963	9	1	5340-00-969-6502	8	66
5305-00-764-0070	7	11	5355-00-767-5008	7	37
5305-00-765-4257	7	40	5355-00-941-6758	7	42
5305-00-770-2580	7	19	5365-00-141-6943	12	12
5310-00-136-1631	7	18	5365-00-754-1562	12	13
5310-00-136-1631	8	69	5905-00-025-5988	11	81
5310-00-208-3786	7	16	5905-00-053-1167	11	49
5310-00-208-3786	8	18	5905-00-063-8405	11	63
5310-00-208-3786	13	8	5905-00-080-2904	11	64
5310-00-208-3786	13	14	5905-00-088-2298	8	71
5310-00-208-9457	8	6	5905-00-088-3354	8	71
5310-00-208-9457	9	4	5905-00-101-1695	11	47
5310-00-209-1074	8	10	5905-00-104-5755	8	57
5310-00-240-6445	8	32	5905-00-104-5755	11	41
5310-00-245-4719	8	49	5905-00-104-5756	11	45
5310-00-263-8462	8	46	5905-00-104-8330	11	80
5310-00-515-8243	8	2	5905-00-104-8334	11	38
5310-00-515-8243	9	2	5905-00-104-8336	11	79
5310-00-543-2740	7	28	5905-00-104-8343	11	39
5310-00-543-2740	8	31	5905-00-104-8348	L1	34
5310-00-685-1450	8	15	5905-00-104-8350	11	77
5310-00-800-5281	7	12	5905-00-106-1276	11	42
5310-00-883-5931	8	47	5905-00-106-9344	11	87
5310-00-928-2690	8	28	5905-00-110-0196	11	40
5310-00-929-6395	8	3	5905-00-110-0310	11	83
5310-00-929-6395	9	3	5905-00-111-4738	11	69
5310-00-933-8118	7	17	5905-00-111-4858	11	82
5310-00-933-8118	8	19	5905-00-114-5352	11	76
5310-00-933-8118	12	3	5905-00-114-5393	11	61
5310-00-933-8118	13	6	5905-00-119-3068	8	29
5310-00-933-8118	13	13	5905-00-126-6691	11	57
5310-00-933-8119	8	9	5905-00-131-5807	11	46

SECTION VII. NATIONAL STOCK NUMBER AND PART NUMBER INDEX (AN/APM-247)

STOCK NUMBER	FIG. NO.	ITEM NO.	STOCK NUMBER	FIG. NO.	ITEM NO.
5905-00-141-0593	8	55	5910-00-165-2797	1	26
5905-00-141-0595	11	68	5910-00-553-6413	8	35
5905-00-141-0596	11	35	5910-00-617-3246	8	35
5905-00-141-0598	11	86	5910-00-649-0544	8	35
5905-00-141-0600	11	90	5910-00-649-1858	8	34
5905-00-141-1165	11	89	5910-00-717-0167	11	1
5905-00-141-1168	11	88	5910-00-773-7984	8	35
5905-00-179-6375	8	71	5910-00-818-9760	11	17
5905-00-189-2460	11	58	5910-00-822-3150	8	35
5905-00-247-8735	11	43	5910-00-880-6080	10	5
5905-00-247-8749	11	44	5910-00-929-0913	11	10
5905-00-421-2942	11	65	5910-00-954-5504	11	30
5905-00-430-1949	11	73	5910-00-957-2054	11	23
5905-00-432-0468	11	74	5910-00-965-9441	11	6
5905-00-432-6410	11	54	5910-00-984-7588	11	29
5905-00-443-8995	11	72	5920-00-280-4465	6	2
5905-00-494-5517	11	78	5920-00-280-4465	7	30
5905-00-539-4900	8	51	5920-00-474-6125	6	3
5905-00-539-5000	8	33	5920-00-474-6125	7	29
5905-00-539-5013	8	61	5920-00-864-6622	7	31
5905-00-721-2380	10	2	5930-00-116-8707	7	6
5905-00-721-2380	11	85	5930-00-116-8711	8	48
5905-00-761-1900	10	1	5930-00-314-3840	8	50
5905-00-761-1900	11	48	5930-00-627-4018	8	54
5905-00-763-5328	11	70	5930-00-685-9520	7	22
5905-00-763-6531	11	53	5930-00-834-6264	7	7
5905-00-801-1208	11	66	5930-00-852-6681	7	33
5905-00-814-0428	8	22	5930-00-872-0565	8	52
5905-00-822-2449	11	71	5930-00-927-7312	8	60
5905-00-824-3057	11	84	5930-00-937-2913	7	24
5905-00-834-6263	11	51	5935-00-064-1870	13	9
5905-00-847-5063	11	91	5935-00-149-3534	6	5
5905-00-878-7168	8	20	5935-00-240-0173	13	2
5905-00-882-1545	8	39	5935-00-259-0205	6	4
5905-00-884-1598	11	67	5935-00-327-9301	13	10
5905-00-892-6475	11	60	5935-00-539-2650	13	1
5905-00-937-7356	11	56	5935-00-717-2591	12	1
5905-00-958-6715	8	24	5935-00-726-0708	7	35
5905-00-988-2307	11	52	5935-00-767-8187	11	8
5905-00-988-2310	10	3	5935-00-773-1744	12	4
5905-00-993-6974	8	71	5935-00-779-8295	13	4
5905-00-993-6974	11	55	5935-00-835-0510	7	21
5905-00-993-8349	7	5	5935-00-836-6522	7	8
5910-00-005-3181	11	14	5935-00-836-6522	12	16
5910-00-008-9263	11	18	5935-00-839-6714	12	11
5910-00-010-4913	11	7	5935-00-850-9157	12	9
5910-00-010-8192	11	5	5935-00-850-9157	13	15
5910-00-110-9195	11	16	5935-00-878-1639	12	6
5910-00-112-7312	8	11	5935-00-930-5929	12	10
3910-00-113-5685	11	20	5935-00-933-1382	7	20

SECTION VII. NATIONAL STOCK NUMBER AND PART NUMBER INDEX (AN/APM-247)

STOCK NUMBER	FIG. NO.	ITEM NO.	STOCK NUMBER	FIG. NO.	ITEM NO.
5935-00-933-1382	7	20	6145-00-103-0712	BULK	
5935-00-937-2265	12	5	6145-00-103-0713	BULK	
5935-00-960-3174	7	15	6145-00-103-0714	BULK	
5940-00-143-4704	8	17	6145-00-103-0716	BULK	
5940-00-269-2219	7	9	6145-00-103-0718	BULK	
5940-00-269-2220	7	10	6145-00-103-0719	BULK	
5940-00-451-5922	7	34	6145-00-103-0720	BULK	
5940-00-501-8634	8	40	6145-00-103-3053	BULK	
5940-00-903-5951	8	67	6145-00-113-3909	BULK	
5950-00-043-0423	11	31	6145-00-113-3910	BULK	
5950-00-707-1243	11	25	6145-00-113-3911	BULK	
5950-00-769-4326	11	32	6145-00-113-6278	BULK	
5950-00-777-4974	11	27	6145-00-147-6413	BULK	
5950-00-778-8624	8	5	6145-00-160-4775	BULK	
5950-00-903-3386	9	5	6145-00-199-8068	BULK	
5950-00-907-8302	8	4	6145-00-295-2810	BULK	
5961-00-060-3926	11	28	6145-00-500-3079	BULK	
5961-00-087-6047	11	4	6145-00-548-0969	BULK	
5961-00-556-2091	11	15	6145-00-578-6824	BULK	
5961-00-713-0913	11	37	6145-00-578-6975	BULK	
5961-00-787-5305	11	2	6145-00-578-6978	BULK	
5961-00-821-2309	11	13	6145-00-581-1621	BULK	
5961-00-830-4796	11	36	6145-00-581-1622	BULK	
5961-00-837-1757	11	21	6145-00-581-1623	BULK	
5961-00-842-9864	11	24	6145-00-581-1624	BULK	
5961-00-844-6717	11	33	6145-00-581-1625	BULK	
5961-00-851-5926	11	9	6145-00-581-1626	BULK	
5961-00-855-1551	11	3	6145-00-581-9324	BULK	
5961-00-877-8618	11	19	6145-00-610-1937	BULK	
5961-00-972-9395	11	11	6145-00-623-7224	BULK	
5961-00-985-9134	11	22	6145-00-623-7225	BULK	
5990-00-715-6695	8	64	6145-00-669-6642	BULK	
5990-00-774-6295	8	63	6145-00-686-4465	BULK	
5990-00-965-0495	8	36	6145-00-686-4939	BULK	
5995-00-926-0820	6	9	6145-00-686-4940	BULK	
5995-00-926-3330	6	10	6145-00-686-4941	BULK	
5995-00-931-1047	6	12	6145-00-721-8921	BULK	
5995-00-933-5385	6	13	6145-00-822-3473	BULK	
5999-00-531-5212	7	14	6145-00-822-3474	BULK	
6145-00-056-8814	BULK		6145-00-822-3475	BULK	
6145-00-060-9083	BULK		6145-00-822-3481	BULK	
6145-00-060-9097	BULK		6145-00-822-4033	BULK	
6145-00-060-9500	BULK		6145-00-838-6994	BULK	
6145-00-060-9503	BULK		6145-00-838-6995	BULK	
6145-00-060-9504	BULK		6145-00-838-9446	BULK	
6145-00-060-9505	BULK		6145-00-880-6380	BULK	
6145-00-060-9507	BULK		6145-00-880-6381	BULK	
6145-00-060-9511	BULK		6145-00-880-6382	BULK	
6145-00-060-9512	BULK		6145-00-880-6388	BULK	
6145-00-080-3022	BULK		6145-00-993-8809	BULK	

SECTION VII. NATIONAL STOCK NUMBER AND PART NUMBER INDEX (AN/APM-247)

STOCK NUMBER	FIG. NO.	ITEM NO.	STOCK NUMBER	FIG. NO.	ITEM NO.
6145-00-993-8811	BULK				
6145-00-009-6429	BULK				
6145-01-012-3975	BULK				
6145-00-542-6882	7	4			
6210-00-923-4466	7	26			
6210-00-923-4467	7	2			
6240-00-155-7857	6	14			
6240-00-155-7857	7	3			
6625-00-132-3748	6	1			
6625-00-926-4403	6	8			
6625-00-935-1368	7	27			
6625-00-997-6245	7	32			
6625-00-998-0061	7	1			

SECTION VII. NATIONAL STOCK NUMBER AND PART NUMBER INDEX (AN/APM-247) (CONTINUED)

PART NUMBER	FSCM	FIG. NO.	ITEM NO.	PART NUMBER	FSCM	FIG. NO.	ITEM NO.
A12429	70674	8	5	MS18130-1	96906	11	32
A205S495KPORM-1	05347	11	75	MS18130-20	96906	11	25
CG-1464U4FT	80058	6	12	MS18130-24	96906	11	31
CL31BG350MPE	81349	11	16	MS20426AD3-4	96906	6	17
CM05ED330G03	81349	11	23	MS20426AD4-4	96906	6	15
CM05FD101G03	81349	11	29	MS25237-328	96906	6	14
CM05FD1210G3	81349	11	30	MS25237-328	96906	7	3
CM06FD102G03	81349	11	6	MS3057-4A	96906	13	2
CM06FD122G03	81349	10	5	MS3102R10SL3P	96906	7	35
CM06FD471G03	81349	11	1	MS3106A10SL3SC	96906	13	1
CP09AIKC333K3	81349	8	35	MS3116F14-19S	96906	13	4
CP53B1EG2541KI	81349	8	11	MS3116F18-32S	96906	12	1
CS11B2A372	86197	8	36	MS3420-16	96906	12	12
CW752APM247	80058	6	1	MS3420-20	96906	12	13
CX10029APM247	80058	6	9	MS35333-74	96906	7	28
CX10242APM247	80058	6	13	MS35333-74	96906	8	31
CX11555APM247	80058	6	10	MS35338-134	96906	8	28
DA15PC33	71468	13	9	M835338-135	96906	7	17
DA15S	71468	7	20	MS35338-135	96906	8	19
DA158C37	711468	13	10	MS35338-135	96906	12	3
DCC705-2248-000	75042	11	62	MS35338-135	96906	13	6
DCS1-219103F	91637	10	6	MS35338-135	96906	13	13
DCS1-249903F	91637	10	4	MS35338-136	96906	8	3
DCS1-249903F	91637	11	59	MS35338-136	96906	9	3
DPX32C2-33S	71468	12	4	MS35338-137	96906	8	9
ES160-0	20418	8	7	MS35338-137	96906	12	8
E20GREEN	81349	BULK		MS35338-139	96906	12	15
FP101M	01121	11	56	MS35649-224	96906	8	27
FP102U	01121	11	84	MS35649-284	96906	8	8
F02A250V1AS	81349	6	2	MS51957-11	96906	6	6
F02A250V1AS	81349	7	30	MS51957-127	96906	12	7
F02A250V2AS	81349	6	3	MS51957-13	96906	8	68
F02A250V2AS	81349	7	29	MS51957-13	96906	13	5
F20WHITE	81349	BULK		MS51957-13	96906	13	12
HKPH	71400	7	31	MS51957-15	96906	8	25
HP11N	09922	8	21	MS51957-15	96906	12	2
HP14N	09922	8	43	MS51957-17	96906	7	36
HP3N	09922	8	56	MS51957-27	96906	8	1
JAN1N270	81349	11	15	MS51957-28	96906	8	42
JAN1N645	81349	11	4	MS51957-43	96906	8	12
JAN1N751A	81349	11	13	MS51957-44	96906	8	44
JAN1N914	81349	11	24	MS51957-5	96906	8	30
JAN1N976B	81349	11	19	MS51957-60	96906	9	9
JAN2N1132	81349	11	3	MS51957-84	96906	12	14
JAN2N404A	81349	11	22	MS51958-62	96906	8	13
JAN2N718A	81349	11	2	MS51959-16	96906	7	19
JSDA19678-1	71468	13	7	MS51959-28	96906	9	1
J8DA19678-1	71468	13	11	MS51959-43	96906	7	40
MF1X000N10004F	91637	11	50	MS51959-46	96906	7	11
MM2946	99974	BULK		MS51963-34	96906	7	38
MS85935-01	08288	12	10	M39003-01-3043	81349	11	20

SECTION VII. NATIONAL STOCK NUMBER AND PART NUMBER INDEX (AN/APM-247) (CONTINUED)

PART NUMBER	FSCM	FIG. NO.	ITEM NO.	PART NUMBER	FSCM	FIG. NO.	ITEM NO.
M39003-01-3097	81349	11	5	NR25	91637	8	22
M39006-09-6515	81349	11	7	RH25X000D100R0H	91637	8	23
M39006-09-6523	81349	11	26	RH25X000K50R00F	91637	8	20
M39012/21-0001	81349	7	21	RNC60K1001FS	81349	11	54
NAS1297R5	80205	8	66	RNC60K1913FS	81349	11	58
NAS1397P4N	80205	8	41	RNC60K1961FS	81349	10	2
NAS1397P6N	80205	8	26	RNC60K1961FS	81349	11	85
NAS1397P8N	80205	8	53	RNC60K3321FS	81349	11	81
NAS1397R7	80205	8	62	RNC60K3923FS	81349	11	74
NAS671C4	80205	7	16	RNC65H1000FS	81349	11	65
NAS671C4	80205	8	18	RNC65K1003FS	81349	11	46
NAS671C4	80205	13	8	RNC65K1960FS	81349	8	71
NAS671C4	80205	13	14	RNC70K1504FS	81349	11	47
PA600-580	71590	7	6	RNC70K2150FS	81349	11	72
PA600-582	71590	7	24	RNC70K42R2FS	81349	11	73
PB01FA01	81349	7	9	RN60C5490F	81349	11	91
PB01FA03	81349	7	10	RN60D1000F	81349	10	3
RCR20G100JS	81349	8	57	RN60D1003F	81349	11	52
RCR20G100JS	81349	11	41	RN60D1021F	81349	11	53
RCR20G101JS	81349	L1	87	RN60D1912F	81349	10	1
RCR20G102JS	81349	11	40	RN60D1912F	81349	11	48
RCR20G104JS	81349	11	79	RN60D2941F	81349	11	70
RCR20G105JS	81349	11	45	RN65D1004F	81349	11	60
RCR20G111JS	81349	11	76	RN65D1470F	81349	8	71
RCR20G150JS	81349	11	57	RN65D1620F	81349	8	71
RCR20G152JS	81349	11	69	RN65D1780F	81349	8	71
RCR20G182JS	81349	8	55	RN65D1780F	81349	11	55
RCR20G221JS	81349	11	77	RN65D1963F	81349	11	64
RCR20G222JS	81349	11	88	RN65D2151F	81349	11	63
RCR20G224JS	81349	11	61	RN70C1473F	81349	11	66
RCR20G331JS	81349	11	38	RN70C2871F	81349	11	71
RCR20C332JS	81349	11	34	RN70D2054F	81349	11	49
RCR20G333JS	81349	11	80	RSM2C20R00F	91637	11	67
RCR20G392JS	81349	11	83	RTE730A915	99114	BULK	
RCR20G471JS	81349	11	82	RV4NAYSD251A	81349	7	5
RCR20G472JS	81349	11	68	RV4NAYSD252A	81349	8	61
RCR20G472KM	81349	11	78	RV4NAYSD503A	81349	8	51
RCR20G473JS	81349	11	35	RV5NAYSD251A	81349	8	33
RCR20G561JS	81349	11	86	SDB1K01105M	53021	11	17
RCR20G682JS	81349	11	89	SDB1K012714J	53021	8	34
RCR20G822JS	81349	11	90	SDB1K031214K	53021	8	35
RCR32G100JS	81349	11	39	SDB1K06154M	53021	11	12
RCR32G104JS	81349	11	42	SMB504565	80063	8	32
RCR32G563JS	81349	11	43	S138	07418	12	11
RCR32G823JS	81349	11	44	TS2081APM247	80058	6	8
RE65G1210	81349	8	24	TX18-1930-0	99114	BULK	
RE75G20R0	81349	8	39	TX18-1930-5	99114	BULK	
RF-6621-78	94375	12	5	TX18-1930-6	99114	BULK	
RG59BU	80058	BULK		UG201AU	80058	6	4
RH-50-11R00G	91637	8	38	UG260FU	80058	12	9
RH10X000D20R00B	91637	8	29	UG260FU	80058	13	15

SECTION VII. NATIONAL STOCK NUMBER AND PART NUMBER INDEX (AN/APM-247) (CONTINUED)

PART NUMBER	FSCM	FIG. NO.	ITEM NO.	PART NUMBER	FSCM	FIG. NO.	ITEM NO.
UG273U	80058	6	5	WTE734ACW913	90484	BULK	
WG910CU	80058	7	8	WTE734ACW915	90484	BULK	
UG910CU	80058	12	16	WTE734ACW916	90484	BULK	
WH65333-01-02-01	50625	BULK		WTE734ACW92	90484	BULK	
WH65333-01-09-01-06-01	50625	BULK		WTE734ACW923	90484	BULK	
WH65333-01-14-01-02-01	50625	BULK		WTE734ACW925	90484	BULK	
WH65333-01-14-01-04-01	50625	BULK		WTE734ACW926	90484	BULK	
WH65333-01-14-01-06-01	50625	BULK		WTE734ACW93	90484	BULK	
WH65333-01-14-01-08-01	50625	BULK		WTE734ACW935	90484	BULK	
WH65333-01-14-01-09-01	50625	BULK		WTE734ACW936	90484	BULK	
WH65333-08-04-01	50625	BULK		WTE734ACW95	90484	BULK	
WH65333-09-06-01	50625	BULK		WTE734ACW956	90484	BULK	
WH66817-93	50625	BULK		WTE734ACW96	90484	BULK	
WH66817-95	50625	BULK		WTE734AC906	90484	BULK	
WH66817-96	50625	BULK		WTE734CW7	90484	BULK	
WTE18A	90484	BULK		XE20728S1-0	28581	BULK	
WTE22A9	90484	BULK		XE20728S1-3	28581	BULK	
WTE728A2	90484	BULK		XE20728S1-7	28581	BULK	
WTE730A1	90484	BULK		XE20728S1-8	28581	BULK	
WTE730A2	90484	BULK		XF2072881-90	28581	BULK	
WTE730A5	90484	BULK		X165-1	81815	11	27
WTE730A6	90484	BULK		01-150	23266	9	7
WTE730A7	90484	BULK		011-378	99743	8	64
WTE730A8	90484	BULK		0167-3	94375	8	67
WTE730A9	90484	BULK		1N3256	80131	11	11
WTE730A903	90484	BULK		1N758	01295	11	28
WTE730A91	90484	BULK		1N986B	81349	11	9
WTE730A92	90484	BULK		1XT22730-4	12515	BULK	
WTE730A93	90484	BULK		1XT22730-95	12515	BULK	
WTE734ACW0	90484	BULK		106064-337	06773	8	37
WTE734ACW1	90484	BULK		109D566X0075T2	56289	11	14
WTE734ACW2	90484	BULK		116-1199	58474	9	5
WTE734ACW3	90484	BULK		126-1069	02660	7	14
WTE734ACW4	90484	BULK		14-30380	87034	7	4
WTE734ACW5	90484	BULK		159344K1	76854	8	50
WTE734ACW6	90484	BULK		1924-02NP	78189	7	13
WTE734ACW8	90484	BULK		196P15493S4	56289	8	35
WTE734ACW9	90484	BULK		196P47491S4	56289	11	18
WTE734ACW90	90484	BULK		197794K8	76854	8	48
WTE734ACW902	90484	BULK		2N388A	80131	11	21
WTE734ACW903	90484	BULK		2N502A	81349	11	33
WTE734ACW905	90484	BULK		203343-000	12436	8	17
WTE734ACW91	90484	BULK		204324F1	76854	8	60
WTICT34ACW912	90484	BULK		2104-04-01-2520N	78189	7	34
				237966K2	76854	8	52
				250-13283	77221	7	32
				255990K6	76854	7	23
				25-0852-00	13499	8	54
				278146	56232	8	6
				278146	56232	9	4

SECTION IV. NATIONAL STOCK NUMBER AND PART NUMBER INDEX (AN/APM-247) (CONTINUED)

PART NUMBER	FSCM	FIG. NO.	ITEM NO.	PART NUMBER	FSCM	FIG. NO.	ITEM NO.
290-13220	77221	7	27	18191321	18876	8	47
30TYPESJ3-18	24342	13	3	8298S	04009	7	25
30723	96214	8	2	829896	04009	7	7
30723	96214	9	2	931-4530-00	13499	8	35
31-1	81073	11	8	931-5000-00	13499	8	35
310-00000	79807	8	10				
310-0049-000	79807	8	15				
310-0052-000	79807	8	49				
310-0073-000	79807	8	14				
310-6340-000	79807	7	18				
310-6340-000	79807	8	69				
313-0064-00	13499	8	46				
329-13219	77221	7	1				
334-0260-00	13499	7	12				
35059K	04009	7	22				
372-1536-000	13499	7	15				
4021	77147	8	40				
41C191	56289	11	10				
421-1820-000	13499	BULK					
421-2020-000	99114	BULK					
421-2220-000	13499	BULK					
425170-01	07690	12	6				
439-4292-00	13499	BULK					
439-4296-DO	13499	BULK					
439-4297-000	13499	BULK					
516-3498-030	13499	8	59				
516-3498-030	13499	9	6				
516-3498-033	13499	6	11				
540-9176-003	13499	8	70				
540-9464-003	13499	8	58				
563-5048-002	13499	8	63				
563-5049-002	13499	8	65				
6P6	87034	7	26				
705-5024-000	13499	11	51				
757-0232-002	13499	7	41				
757-0232-004	13499	7	43				
757-0233-001	13499	7	37				
757-0233-004	13499	7	42				
757-0233-005	13499	7	39				
76-0093-70	95105	8	4				
764-8581-001	13499	9	8				
764-8590-001	13499	8	16				
766-0529-001	13499	6	18				
766-0530-001	13499	6	16				
766-0530-008	13499	6	7				
7665K4M0D	15605	7	33				
7717-22DAP	13103	11	37				
7717-63	13103	11	36				
78959H3	76854	8	45				
8P6	87034	7	2				

By Order of the Secretary of the Army:

Official:

PAUL T. SMITH
Major General, United States Army
The Adjutant General

FRED C. WEYAND
General, United States Army
Chief of Staff

DISTRIBUTION:

To be distributed in accordance with DA Form 12HA, Organizational maintenance requirements for AN/APM-246 and AN/APM-247.

* U S GOVERNMENT PRINTING OFFICE 1982 0 - 389-381

RECOMMENDED CHANGES TO EQUIPMENT TECHNICAL PUBLICATIONS



THEN... JOT DOWN THE DOPE ABOUT IT ON THIS FORM, CAREFULLY TEAR IT OUT, FOLD IT AND DROP IT IN THE MAIL!

SOMETHING WRONG WITH THIS PUBLICATION?

FROM: (PRINT YOUR UNIT'S COMPLETE ADDRESS)

DATE SENT

PUBLICATION NUMBER

PUBLICATION DATE

PUBLICATION TITLE

BE EXACT... PIN-POINT WHERE IT IS

PAGE NO.	PARA-GRAPH	FIGURE NO.	TABLE NO.

IN THIS SPACE TELL WHAT IS WRONG AND WHAT SHOULD BE DONE ABOUT IT:

TEAR ALONG PERFORATED LINE

PRINTED NAME, GRADE OR TITLE, AND TELEPHONE NUMBER

SIGN HERE:

DA FORM 2028-2
1 JUL 79

PREVIOUS EDITIONS ARE OBSOLETE.

P.S.—IF YOUR OUTFIT WANTS TO KNOW ABOUT YOUR RECOMMENDATION MAKE A CARBON COPY OF THIS AND GIVE IT TO YOUR HEADQUARTERS.

